



EURO RICAMBI SrL

VIA P. TOGLIATTI 5/E
41030 SORBARA DI BOMPORTO MO



CATALOGO PIEDINI

TEL. 059/9776050

FAX. 059/9776053

info@euroricambi.it
vendite@euroricambi.it

PIEDINI PER MACCHINE FAMIGLIA

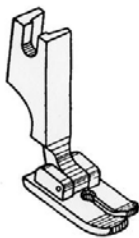

111C00002
Cucit. Diritta A/ALTO

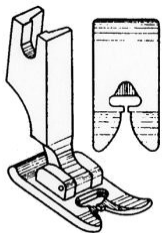

111C00001
Zig Zag A/ALTO

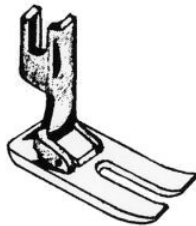

111C000314
Cucit. Diritta A/ALTO teflon

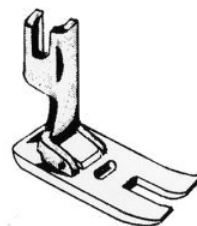

111C000311
Zig Zag A/ALTO teflon

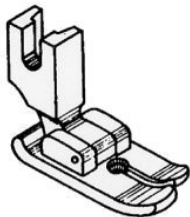

111C000017
Cucit. Diritta A/BASSO

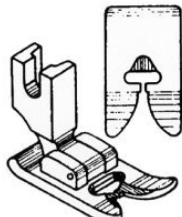

111C000020
Zig Zag A/BASSO



111C000313
Cucit. Diritta A/BASSO teflon

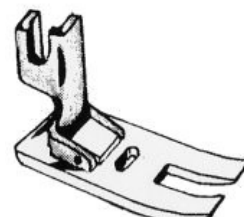

111C000310
Zig Zag A/BASSO teflon

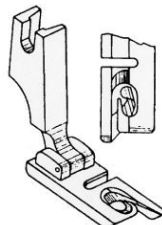

111CCC0A15
A/ALTO Z/Z orlo arrot. mm. 1,5

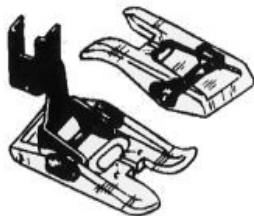

111C000308
A/ALTO Z/Z trasparente

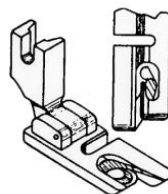

111CCC0B15
A/BASSO Z/Z orlo arrot. mm. 1,5

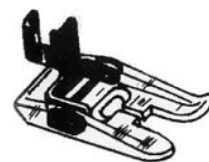

111C000309
A/BASSO Z/Z trasparente

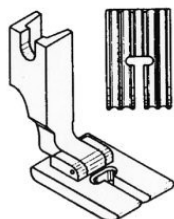

A/ALTO per piegoline
111C000011 5 piegoline
111C000012 7 piegoline
111C000013 9 piegoline

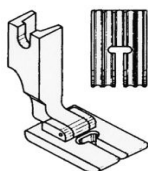

Attacco BASSO per piegoline
111C000014 5 piegoline
111C000015 7 piegoline
111C000016 9 piegoline



Compensatore destro
Attacco BASSO

111C000018 1.0 mm
111C000003 1.5 mm
111C000004 2.0 mm
111C000005 3.0 mm
111C000006 4.0 mm
111C000007 5.0 mm



111C000009
A/ALTO orlo piatto cucit. diritta mm. 5,0

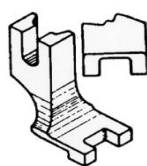

111C000028
A/BASSO per bottoni

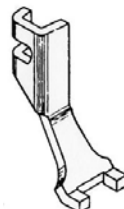

111C000010
A/ALTO per bottoni

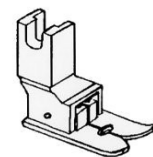

111C000019
Comp. Z/Z A/BASSO mm. 6

ASOLATORI AUTOMATICI



111C000317
Attacco ALTO 1932H

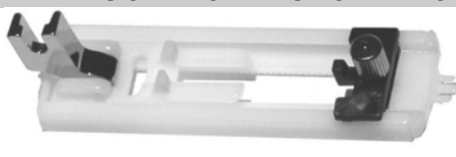

111C000316
Attacco BASSO 1932L

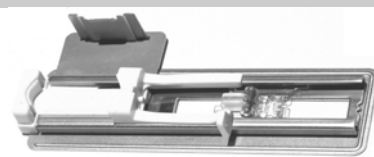

111C000331
Singer 381277

PIEDINI CON ATTACCO SNAP

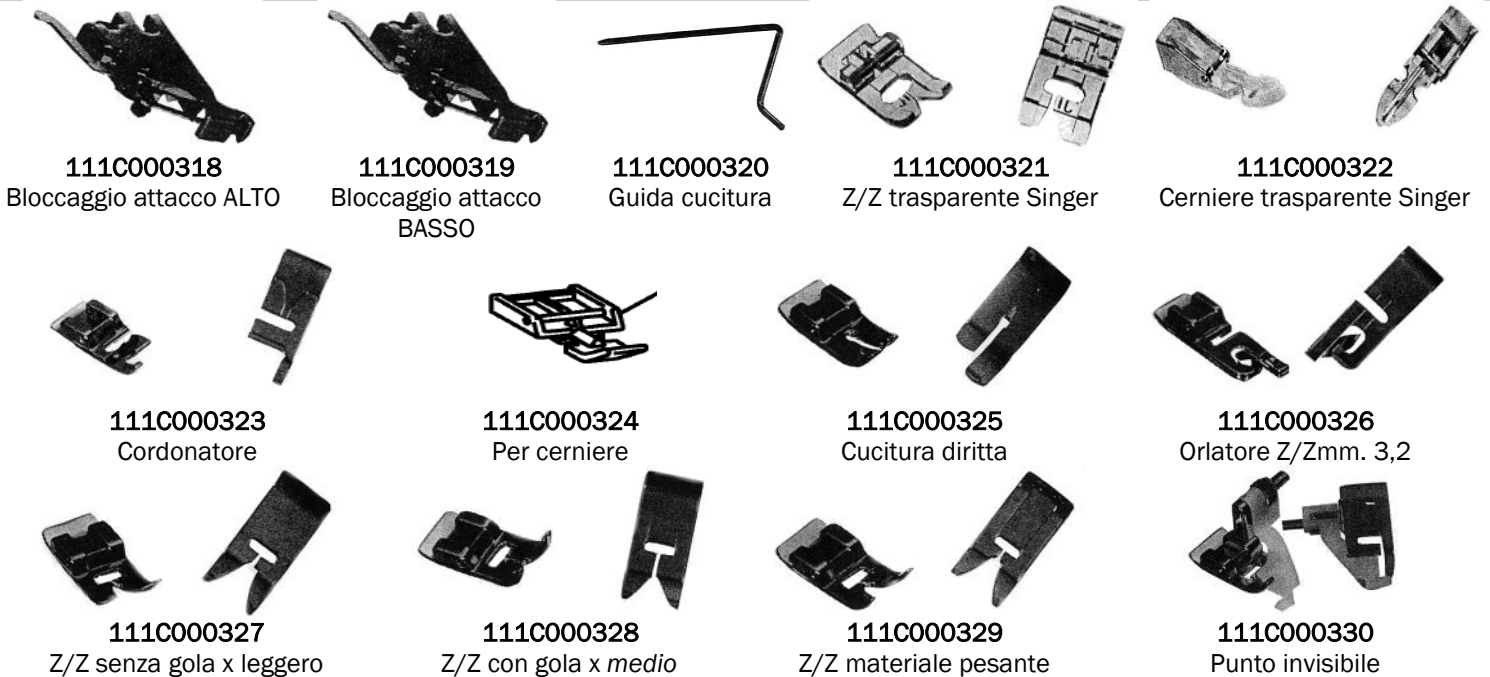

PIEDINI ORLATORI

| Codice | Misura |
|-------------------|-------------|
| 111C000029 | 1/16" = 1,6 |
| 111C000030 | 5/64" = 2,0 |
| 111C000031 | 3/32" = 2,4 |
| 111C000032 | 1/8" = 3,2 |
| 111C000033 | 5/32" = 4,0 |
| 111C000034 | 3/16" = 4,8 |
| 111C000035 | 7/32" = 5,6 |
| 111C000036 | .1/4" = 6,4 |
| 111C000037 | 5/16" = 8,0 |

| PIEGA SEMPLICE | |
|-------------------|-------------|
| Codice | Misura |
| 111C000044 | 1/8" = 3,2 |
| 111C000045 | 3/16" = 4,8 |
| 111C000046 | 7/32" = 5,6 |
| 111C000047 | .1/4" = 6,4 |
| 111C000048 | 5/16" = 8,0 |

Orlo piega doppia superiore per tessuti molto leggeri

111C000040 1/16" = 1,6
111C000041 1/8" = 3,2
111C000042 3/16" = 4,8
111C000043 .1/4" = 6,4

Orlo semplice con piega destra superiore

111C000050 3/16" = 4,8
111C000051 .1/4" = 6,4

Orlo semplice con piega destra inferiore

111C000052 3/16" = 4,8
111C000053 .1/4" = 6,4

Orlo semplice con piega sinistra inferiore

111C000054 3/16" = 4,8
111C000055 .1/4" = 6,4

Orlo semplice per l'unione di due tessuti

111C000056 3/16" = 4,8
111C000057 .1/4" = 6,4

PIEDINI ARRICCIATORI

110C000058

Regolabile con salvadito

111CP952

 Senza salvadito
P952

110C000059

Regolabile con salvadito

111C950

 Senza salvadito
950

111C000062

Scalino regolare

P50

111C000063

Scalino medio

P50M

111C000064

Scalino ALTO

P50H



111C000065

 Scalino regolare stretto
P50N

111C000060

 Inserimento nastro regolare
P5 mm. 3

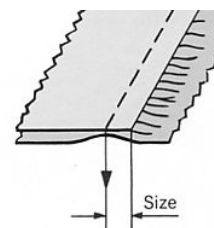
111C000061

 Inserimento nastro largo
P5W mm.10

PIEDINI COMPENSATORI IN POLLICI
DESTRO

| Misura | Originale | Con Salvadito | Senza salvadito |
|-------------|-----------|-------------------|-----------------|
| 1/32" = 0,8 | 21 | 111C000066 | 111C21 |
| 1/16" = 1,6 | 211 | 111C000067 | 111C211 |
| 3/32" = 2,4 | | 111C000068 | 111C332 |
| 1/8" = 3,2 | 212 | 111C000069 | 111C212 |
| 5/32" = 4,0 | | 111C000070 | 111C532 |
| 3/16" = 4,8 | 213 | 111C000071 | 111C213 |
| 1/4" = 6,4 | 214 | 111C000072 | 111C214 |
| 5/16" = 8,0 | 215 | 111C000073 | 111C215 |
| 3/8" = 9,5 | 216 | 111C000074 | 111C216 |
| 1/2" = 12,7 | 218 | 111C000075 | 111C218 |

SINISTRO

| Misura | Originale | Con Salvadito | Senza salvadito |
|-------------|-----------|-------------------|-----------------|
| 1/32" = 0,8 | 22 | 111C000081 | 111C22 |
| 1/16" = 1,6 | 221 | 111C000082 | 111C221 |
| 1/8" = 3,2 | 222 | 111C000083 | 111C222 |
| 3/16" = 4,8 | 223 | 111C000084 | 111C223 |
| 1/4" = 6,4 | 224 | 111C000085 | 111C224 |
| 5/16" = 8,0 | 225 | 111C000086 | 111C225 |
| 3/8" = 9,5 | 226 | 111C000087 | 111C226 |
| 1/2" = 12,7 | 228 | 111C000088 | 111C228 |

PIEDINI COMPENSATORI IN MILLIMETRI
DESTRO MM.

| Misura | | Senza salvadito |
|---------|------|-----------------|
| mm. 1,0 | CR10 | 111CCR10 |
| mm. 1,5 | CR15 | 111CCR15 |
| mm. 2,0 | CR20 | 111CCR20 |
| mm. 2,5 | CR25 | 111CCR25 |
| mm. 3,0 | CR30 | 111CCR30 |
| mm. 4,0 | CR40 | 111CCR40 |
| mm. 5,0 | CR50 | 111CCR50 |
| mm. 6,0 | CR60 | 111CCR60 |
| mm. 7,0 | CR70 | 111CCR70 |
| mm. 8,0 | CR80 | 111CCR80 |

SINISTRO MM.

| Misura | | Senza salvadito |
|---------|------|-----------------|
| mm. 1,0 | CL10 | 111CCL10 |
| mm. 1,5 | CL15 | 111CCL15 |
| mm. 2,0 | CL20 | 111CCL20 |
| mm. 2,5 | CL25 | 111CCL25 |
| mm. 3,0 | CL30 | 111CCL30 |
| mm. 4,0 | CL40 | 111CCL40 |
| mm. 5,0 | CL50 | 111CCL50 |
| mm. 6,0 | CL60 | 111CCL60 |
| mm. 7,0 | CL70 | 111CCL70 |
| mm. 8,0 | CL80 | 111CCL80 |

COMPENSATORI STRETTI
E
SUPERSTRETTI

| DESTRO STRETTO | | | |
|------------------|-----------|-------------------|-----------------|
| Misura | Originale | Con Salvadito | Senza salvadito |
| 1/32" = 0,8 | 210R | 111C000076 | 111C210 |
| 1/16" = 1,6 | 211N | 111C000077 | 111C116D |
| SINISTRO STRETTO | | | |
| Misura | Originale | Con Salvadito | Senza salvadito |
| 1/32" = 0,8 | 220L | 111C000078 | 111C220 |
| 1/16" = 1,6 | 221N | 111C000079 | 111C116S |



| DESTRO STRETTISSIMO | |
|-----------------------|------------------|
| Originale | Senza salvadito |
| 210RN | 111C210RN |
| 211NN | 111C211NN |
| SINISTRO STRETTISSIMO | |
| Originale | Senza salvadito |
| 220LN | 111C220LN |
| 221NN | 111C221NN |

COMPENSATORI DOPPI

| Misura | Originale | Con Salvadito | Senza salvadito |
|-------------|-----------|-------------------|-----------------|
| 1/32" = 0,8 | 23 | 111C000089 | 111C23 |
| 1/16" = 1,6 | 231 | 111C000090 | 111C231 |
| STRETTO | | | |
| Misura | Originale | Con Salvadito | Senza salvadito |
| 1/32" = 0,8 | 230 | 111C000080 | 111C230 |

COMPENSATORI PER TESSUTI LEGGERI

| Misura | Originale | Con Salvadito | Senza salvadito |
|--------------|-----------|-------------------|------------------|
| 1/32" = 0,8 | CR1/32"K | 111C000091 | 111C21K |
| 1/32" N= 0,8 | CR1/32"NK | - | 111C210K |
| 1/16" = 1,6 | CR1/16"K | 111C000092 | 111C211K |
| 1/16" N= 1,6 | CR1/16"NK | - | 111C211NK |
| 3/32" = 2,4 | CR3/32"K | 111C000093 | 111C332K |
| 1/8" = 3,2 | CR1/8"K | 111C000094 | 111C212K |
| 5/32" = 4,0 | CR5/32"K | 111C000095 | 111C532K |
| 3/16" = 4,8 | CR3/16"K | 111C000096 | 111C213K |
| 1/4" = 6,4 | CR1/4"K | 111C000097 | 111C214K |
| 5/16" = 8,0 | CR5/16"K | 111C000098 | 111C215K |
| 3/8" = 9,5 | CR3/8"K | 111C000099 | 111C216K |
| 1/2" = 12,7 | CR1/2"K | 111C000100 | 111C218K |

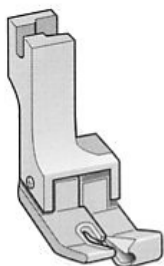
COMPENSATORI IN TEFLON

| DESTRO | | | | |
|-------------|-----------|-------------------|------------------|----------------------|
| Misura | Originale | Con Salvadito | Senza salvadito | Ciabatta di ricambio |
| 1/32" = 0,8 | MT 21 R | 111C000350 | 111CT21R | 111C000360 |
| 1/16" = 1,6 | MT 211 R | 111C000351 | 111CT211R | 111C000361 |
| 1/8" = 3,2 | MT 212 R | 111C000353 | 111CT212R | 111C000363 |
| 3/16" = 4,8 | MT 213 R | 111C000354 | 111CT213R | 111C000364 |
| 1/4" = 6,4 | MT 214 R | 111C000355 | 111CT214R | 111C000365 |
| 5/16" = 8,0 | MT 215 R | 111C000356 | 111CT215R | 111C000366 |
| 3/8" = 9,5 | MT 216 R | 111C000357 | 111CT216R | 111C000367 |
| SINISTRO | | | | |
| Misura | Originale | Con Salvadito | Senza salvadito | Ciabatta di ricambio |
| 1/32" = 0,8 | MT 22 | 111CT22RS | 111CT22R | 111CT22RB |
| 1/16" = 1,6 | MT 221 | 111CT221S | 111CT221 | 111CT221B |
| 1/8" = 3,2 | MT 222 | 111CT222S | 111CT222 | 111CT222B |
| 3/16" = 4,8 | MT 223 | 111CT223S | 111CT223 | 111CT223B |
| 1/4" = 6,4 | MT 224 | 111CT224S | 111CT224 | 111CT224B |
| 5/16" = 8,0 | MT 225 | 111CT225S | 111CT225 | 111CT225B |
| 3/8" = 9,5 | MT 226 | 111CT226S | 111CT226 | 111CT226B |

COMPENSATORI ZIG ZAG

Per bordatore
111CZB0035
 Z/Z mm. 3,5
111CZB0050
 Z/Z mm. 5



111CZDS050
 Z/Z mm. 5 destro
111CZSN050
 Z/Z mm. 5 sinistro



111CZD0030
 Z/Z mm. 3 doppio
111CZD0050
 Z/Z mm. 5 doppio

RICAMBI PER COMPENSATORI

| Codice | Piedino | Codice | Piedino |
|-------------------|---|-------------------|---|
| 111C000101 | 21,211,22,221,CR10, CR15,CL10,CL15, MT21R, MT211R | 111C000113 | Molla piccola 21,22,23,210,220, 230,211,221,231 |
| 111C000102 | 210,23,231, 230 | | |
| 111C000103 | 212,222,CR20,CR25, CR30,CL20,CL25, CL30, MT212R | 111C000114 | Molla grande 212,222,213,223, 214,224,215,225, 226,216,218,228 |
| 111C000104 | 213,223,CR40,CR50, CL40,CL50,MT213 | | |
| 111C000105 | 214,224,CR60,CL60, MT214R | | |
| 111C000110 | 215,225,CR70,CR80, CL70,CL80,MT215R | | |
| 111C000112 | 216,218,226,228, MT216R | | |

COMPENSATORI A DUE IMPUNTURE CON UN SOLO PIEDINO

| I° Impuntura A | II° Impuntura B | Tot.mm | Originale | Con Salvadito | Senza salvadito |
|----------------|-----------------|--------|-----------|-------------------|------------------|
| 1/32" = 0,8 | 3/16" = 4,8 | 5,6 | 21-13 | - | 111C2113 |
| 1/32" = 0,8 | .1/4" = 6,4 | 7,2 | 21-14 | 111C000106 | 111C2114 |
| 1/32" = 0,8 | 5/16" = 8,0 | 8,8 | 21-15 | 111C000107 | 111C2115 |
| 1/32" = 0,8 | 3/8" = 9,5 | 10,2 | 21-16 | - | 111C2116 |
| 1/16" = 1,6 | 3/16" = 4,8 | 6,4 | 211-13 | - | 111C21113 |
| 1/16" = 1,6 | .1/4" = 6,4 | 8,0 | 211-14 | 111C000108 | 111C21114 |
| 1/16" = 1,6 | 5/16" = 8,0 | 9,6 | 211-15 | 111C000109 | 111C21115 |
| 1/16" = 1,6 | 3/8" = 9,5 | 11,1 | 211-16 | - | 111C21116 |

COMPENSATORI PER BORDATORI

111C000278
da 3/4" a 7/8"
601



111C000279
da 1" a 1,1/8"
602



111C000280
da 1,1/4" a 2"
604



111C000281
da 6 mm. a 18 mm.
S543

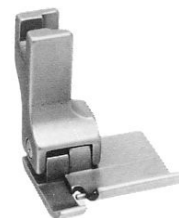

111C000282
da 20 mm. a 24 mm.
S544



111CNL31S
Compensatore sinistro guida
sinistra



111CNR31S
Compensatore destro guida
destra

PIEDINI CON GUIDA FISSA

| DESTRO RIGHT | |
|-------------------|-------------|
| Codice | Misura |
| 111C000116 | 1/32" = 0,8 |
| 111C000117 | 1/16" = 1,6 |
| 111C000118 | 1/8" = 3,2 |
| 111C000119 | 3/16" = 4,8 |
| 111C000120 | .1/4" = 6,4 |
| 111C000121 | 5/16" = 8,0 |
| 111C000122 | 3/8" = 9,5 |
| 111C000123 | 1/2" = 12,7 |



| SINISTRO LEFT | |
|-------------------|-------------|
| Codice | Misura |
| 111C000124 | 1/32" = 0,8 |
| 111C000125 | 1/16" = 1,6 |
| 111C000126 | 1/8" = 3,2 |
| 111C000127 | 3/16" = 4,8 |
| 111C000128 | .1/4" = 6,4 |
| 111C000129 | 5/16" = 8,0 |
| 111C000130 | 3/8" = 9,5 |
| 111C000131 | 1/2" = 12,7 |

PIEDINI CON GUIDA MOBILE

| DESTRO RIGHT | |
|------------------|-------------|
| Codice | Misura |
| 111C18132 | 1/32" = 0,8 |
| 111C18116 | 1/16" = 1,6 |
| 111C18332 | 3/32" = 2,4 |
| 111C1818 | 1/8" = 3,2 |
| 111C18316 | 3/16" = 4,8 |
| 111C1814 | .1/4" = 6,4 |
| 111C18516 | 5/16" = 8,0 |



| SINISTRO LEFT | |
|------------------|-------------|
| Codice | Misura |
| 111C18132 | 1/32" = 0,8 |
| 111C18116 | 1/16" = 1,6 |
| 111C18332 | 3/32" = 2,4 |
| 111C1818 | 1/8" = 3,2 |
| 111C18316 | 3/16" = 4,8 |
| 111C1814 | .1/4" = 6,4 |
| 111C18516 | 5/16" = 8,0 |

PIEDINI CON GUIDA ELASTICA

| Codice | Misura |
|-------------------|-------------|
| 111C000132 | 1/32" = 0,8 |
| 111C000133 | 1/16" = 1,6 |
| 111C000134 | 3/32" = 2,4 |
| 111C000135 | 1/8" = 3,2 |
| 111C000136 | 3/16" = 4,8 |
| 111C000137 | .1/4" = 6,4 |
| 111C000138 | 5/16" = 8,0 |
| 111C000139 | 3/8" = 9,5 |
| 111C000140 | 1/2" = 12,7 |



111C000141
Guida elastica
Da 1/32" a 3/16"

111C000142
Guida elastica
Da 1/4" a 1/2"

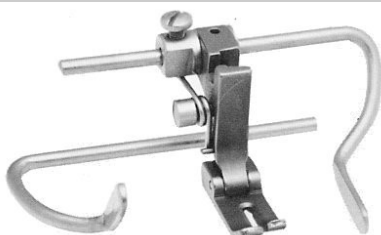
PIEDINI OVATTATORI

111C000143
Guida regolabile destra e sinistra con salvadito
111CP723
Senza salvadito



111C000144
Guida regolabile a destra
Da 1,5 a 25 mm



111C000145
Mezzo ovattatore guida destra
Da 1,5 a 25 mm



111C000146
Mezzo ovattatore rigido guida destra
Da 1,5 a 25 mm

PIEDINI CORDONATORI

111C000148
Mobile destro largo con salvadito
111CP36
Senza salvadito



111C000149
Mobile destro stretto con salvadito
111CP36N
Senza salvadito



111C000150
Mobile sinistro largo con salvadito
111CP36L
Senza salvadito



111C000151
Mobile sinistro stretto con salvadito
111CP36LN
Senza salvadito



111C000154
Rigido sinistro largo con salvadito
111C31358W
Senza salvadito



111C000147
Cordonatore destro e sinistro ALTO
111C000312
Cordonatore destro e sinistro BASSO



111C000152
Rigido destro largo con salvadito
111C12435W
Senza salvadito



111C000153
Rigido destro stretto con salvadito
111C12435N
Senza salvadito



111C000155
Rigido sinistro stretto con salvadito
111C31358N
Senza salvadito

PIEDINI PER CERNIERE



111C000156
Rigido con foro



111C000157
Rigido con fessura



111C000158
Rigido con taglio e
salvadito
111CP3
Senza salvadito



111C000159
Mobile con taglio e
salvadito
111CP363
Senza salvadito



111C000160
Mobile rialzato con
salvadito
111CP363V
Senza salvadito



111C000161
Mobile pari con salv.
111CP58W
Senza salvadito



111C000162
Mobile destro con salv.
111CP361
Senza salvadito



111C000163
Mobile sinistro con salv.
111CP360
Senza salvadito



111C000164
Cern. invisibile con salv.
111CS518
Senza salvadito



111C0S518N
Cern. invisibili con indice
e salvadito
111CS518N
Senza salvadito

PIEDINI A BILANCINO



111CBILU20
Bilancino per macchine piane
1 ago 2mm.



111CBIZZ50
Bilancino per macchine piane
Z/Z 5mm.

PIEDINI NORMALI



111C000165
Rigido ciabatta pari



111C000167
Mobile stretto con salv.
111CP58N
Senza salvadito



111C000168
Mobile regolare con salv.
111CP35
Senza salvadito



111C000169
Mobile sottili con salv.
111CP351K
Senza salvadito



111C000170
Mobile largo con salv.
111CP193
Senza salvadito



111C000171
Mobile molto largo con salv.
111CP127
Senza salvadito



111C000172
Mobile pari nylon con salv.



111C000173
Mobile pari largo con salv.
111CP144H
Senza salvadito



111C000174
Mobile pari inclinata con salv.
111CP144HL
Senza salvadito

PIEDINI ZIG ZAG



111CB11994
Brother 111994-001



111CB12800
Brother 112800-001 mm. 3



111CP54501
91-054501-03C
Pfaff cl. 438



111CP55030
91-055030
Pfaff cl. 438



111CS41566
541566 mm. 10

111CB12805
Brother 112805-001 mm. 5



111CS41781
541781 mm. 10



111CS43939
543939 mm. 12

PIEDINI SCANALATI



Rigido Scanalatura destra



Rigido scanalatura sinistra

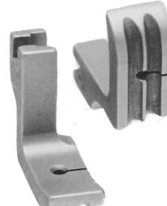

Rigido scanalatura doppia



Rigido scan.sinistra con foro

| Codice | Misura | Codice | Misura | Codice | Misura | Codice | Misura |
|-------------------|-------------|-------------------|-------------|-------------------|-------------|-------------------|-------------|
| 111C000175 | 1/8" = 3,2 | 111C000180 | 1/8" = 3,2 | 111C000185 | 1/8" = 3,2 | 111C000217 | 1/8" = 3,2 |
| 111C000176 | 3/16" = 4,8 | 111C000181 | 3/16" = 4,8 | 111C000186 | 3/16" = 4,8 | 111C000218 | 3/16" = 4,8 |
| 111C000177 | 1/4" = 6,4 | 111C000182 | 1/4" = 6,4 | 111C000187 | 1/4" = 6,4 | 111C000219 | 1/4" = 6,4 |
| 111C000178 | 3/8" = 9,5 | 111C000183 | 3/8" = 9,5 | | | | |
| 111C000179 | 1/2" = 12,7 | 111C000184 | 1/2" = 12,7 | | | | |



Cordonatore rigido scanalato dx



Cordonatore rigido scanalato sx

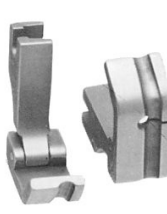

Mobile scanalatura dx

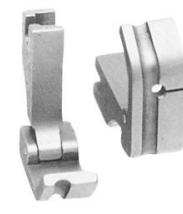

Mobile scanalatura sx

| Codice | Misura | Codice | Misura | Codice | Misura | Codice | Misura |
|-------------------|-------------|-------------------|-------------|-------------------|-------------|-------------------|-------------|
| 111C000188 | 1/8" = 3,2 | 111C000191 | 1/8" = 3,2 | 111C000194 | 1/8" = 3,2 | 111C000197 | 1/8" = 3,2 |
| 111C000189 | 3/16" = 4,8 | 111C000192 | 3/16" = 4,8 | 111C000195 | 3/16" = 4,8 | 111C000198 | 3/16" = 4,8 |
| 111C000190 | 1/4" = 6,4 | 111C000193 | 1/4" = 6,4 | 111C000196 | 1/4" = 6,4 | 111C000199 | 1/4" = 6,4 |

PIEDINI GREZZI RIGIDI

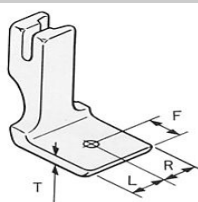

Posizione foro ago e spessore suola



111C000210
Ciabatta rialzata

L: 6mm
R: 6mm
T: 3mm
L=6mm
R=6mm
T=3mm



111C000211
Foro al centro

F: 15mm
L: 10mm
R: 10mm
T: 6mm
L=10mm
R=10mm
T=6mm
F=15mm



111C000212
Foro a sinistra

F: 15mm
L: 6mm
R: 11mm
T: 6mm
L=6mm
R=11mm
T=6mm
F=15mm

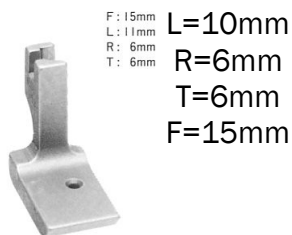

F: 15mm
L: 11mm
R: 6mm
T: 6mm
L=10mm
R=6mm
T=6mm
F=15mm

111C000213
Foro a destra



F: 14mm
L: 11mm
R: 11mm
T: 7mm
L=11mm
R=11mm
T=7mm
F=15mm

111C000214
Foro al centro



F: 15mm
L: 6mm
R: 6mm
T: 3mm
L=6mm
R=6mm
T=3mm
F=15mm

111C000215
Foro al centro

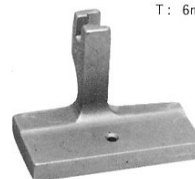

F: 15mm
L: 22mm
R: 22mm
T: 6mm
L=22mm
R=22mm
T=6mm
F=15mm

111C000216
Foro al centro

PIEDINI IN TEFLON

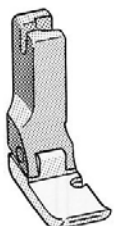

111C000220
Cordonatore destro
largo con salvadito
111CT36
Senza salvadito

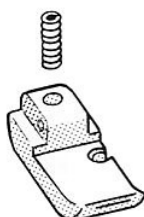

111C000221
Suola di ricambio
per 000220/T36



111C000222
Cordonatore destro
stretto con salvadito
111CT36N
Senza salvadito



111C000223
Suola di ricambio
per
000222/T36N

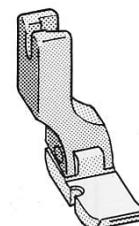

111C000224
Cordonatore sinistro
largo con salvadito
111CT36L
Senza salvadito

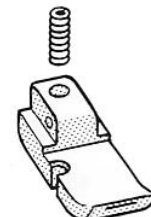

111C000225
Suola di
ricambio per
000224/T36L

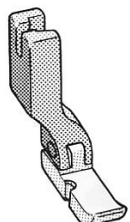

111C000226
Cordonatore destro
stretto con salvadito
111CT36LN
Senza salvadito



111C000227
Suola di ricambio
per
000226/T36LN



111C000228
Suola pari con
salvadito mm. 11
111CT35
Senza salvadito

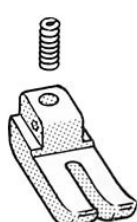

111C000229
Suola di ricambio
per 000228/T35

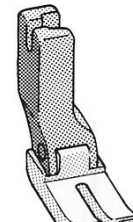

111C000230
Suola pari con
salvadito mm. 12,5
111CT35W
Senza salvadito

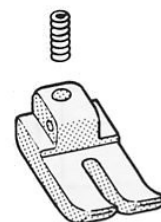

111C000231
Suola di ricambio
per 000230/T35W



111C000232
Foro con salvadito
111CT35C
Senza salvadito
mm. 11



111C000233
Suola di ricambio
per
000232/T35C

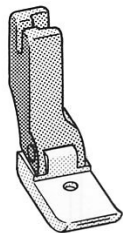

111C000234
Foro con salvadito
111CT35CW
Senza salvadito
mm. 12,5

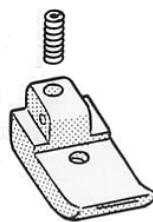

111C000235
Suola di ricambio
per
000234/T35CW



111C000238
Fessura con salvadito
111CT363
Senza salvadito



111C000239
Suola di ricambio
per 000238/T363



111C000240
Regolare con
salvadito
111CT350
Senza salvadito

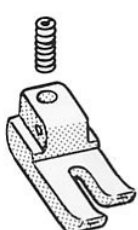

111C000241
Suola di ricambio
per 000240/T350

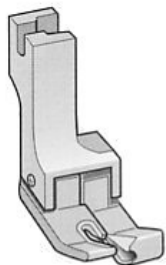

111COSRDBW
Doppio anello nylon
111COSRDBH
Anello di ricambio

COMPENSATORI IN TEFLON

| DESTRO RIGHT | | | | |
|---------------|-----------|-------------------|------------------|----------------------|
| Misura | Originale | Con Salvadito | Senza salvadito | Ciabatta di ricambio |
| 1/32" = 0.8 | MT 21 R | 111C000350 | 111CT21R | 111C000360 |
| 1/16" = 1.6 | MT 211 R | 111C000351 | 111CT211R | 111C000361 |
| 1/8" = 3.2 | MT 212 R | 111C000353 | 111CT212R | 111C000363 |
| 3/16" = 4.8 | MT 213 R | 111C000354 | 111CT213R | 111C000364 |
| 1/4" = 6.4 | MT 214 R | 111C000355 | 111CT214R | 111C000365 |
| 5/16" = 8.0 | MT 215 R | 111C000356 | 111CT215R | 111C000366 |
| 3/8" = 9.5 | MT 216 R | 111C000357 | 111CT216R | 111C000367 |
| SINISTRO LEFT | | | | |
| Misura | Originale | Con Salvadito | Senza salvadito | Ciabatta di ricambio |
| 1/32" = 0.8 | MT 22 R | 111CT22RS | 111CT22R | 111CT22RB |
| 1/16" = 1.6 | MT 221 | 111CT221S | 111CT221 | 111CT221B |
| 1/8" = 3.2 | MT 222 | 111CT222S | 111CT222 | 111CT222B |
| 3/16" = 4.8 | MT 223 | 111CT223S | 111CT223 | 111CT223B |
| 1/4" = 6.4 | MT 224 | 111CT224S | 111CT224 | 111CT224B |
| 5/16" = 8.0 | MT 225 | 111CT225S | 111CT225 | 111CT225B |
| 3/8" = 9,5 | MT 226 | 111CT226S | 111CT226 | 111CT226B |

TEFLON PER RISUOLARE

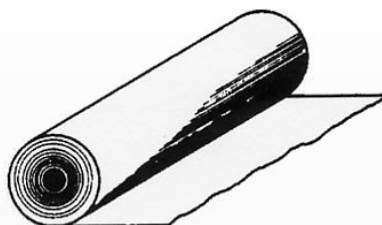

111C000502
Colla per teflon
Glue for teflon

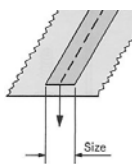

| Codice | Tipo | Spessore | Larghezza | Lunghezza rotolo |
|-------------------|-----------|----------|-----------|------------------|
| 111C000501 | Cementato | 1,00 mm | 400 mm | 1,2 mt |
| 111C000504 | Adesivo | 0,18 mm | 25 mm | 10 mt |
| 111C000505 | Adesivo | 0,18 mm | 50 mm | 10 mt |
| 111C000503 | Adesivo | 0,50 mm | 25 mm | 15 mt |

PIEDINI CON TUBO GUIDA NASTRO

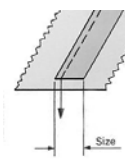
| Tubo al centro | |
|-------------------|-------------|
| Codice | Misura |
| 111C31800C | 1/8" = 3,2 |
| 111C33160C | 3/16" = 4,8 |
| 111C000242 | 1/4" = 6,4 |
| 111C33800C | 3/8" = 9,5 |
| 111C000243 | 1/2" = 12,7 |



| Tubo a destra | |
|-------------------|-------------|
| Codice | Misura |
| 111C31800R | 1/8" = 3,2 |
| 111C33160R | 3/16" = 4,8 |
| 111C000244 | 1/4" = 6,4 |
| 111C33800R | 3/8" = 9,5 |
| 111C000245 | 1/2" = 12,7 |

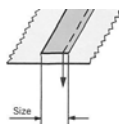

| Tubo a sinistra | |
|-------------------|-------------|
| Codice | Misura |
| 111C31800L | 1/8" = 3,2 |
| 111C33160L | 3/16" = 4,8 |
| 111C000246 | 1/4" = 6,4 |
| 111C33800L | 3/8" = 9,5 |
| 111C000247 | 1/2" = 12,7 |

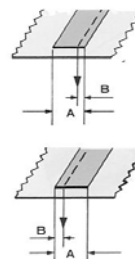

111C000250
Tubo regolabile
A=0~55 mm.
B=7~55 mm.

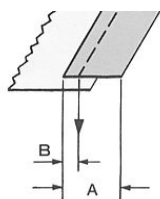
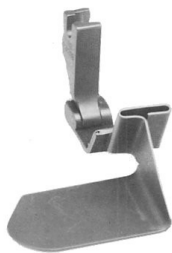

111C000248
Tubo a destra
A=12,7 mm. B=4 mm.

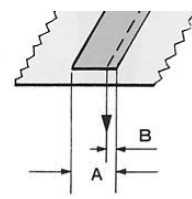
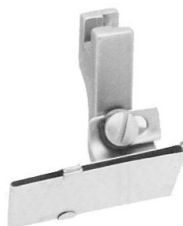

111C000249
Tubo regolabile a sinistra
A=0~30 mm. e B=0~12 mm.

PIEDINO PER ELASTICO ELASTIC SHIRRING FOOT

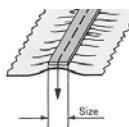

| Codice | Misura |
|-------------------|-------------|
| 111C000251 | 1/8" = 3,2 |
| 111C000252 | 3/16" = 4,8 |
| 111C000253 | 1/4" = 6,4 |
| 111C000254 | 3/8" = 9,5 |
| 111C000255 | 1/2" = 12,7 |

PIEDINI CON BORDATORI BIAS PIPING FEET

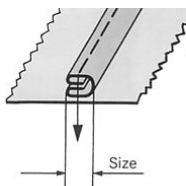

| Bordatore piega doppio | |
|------------------------|---------|
| Codice | Misura |
| 111C000256 | 3 mm. |
| 111C000257 | 5 mm. |
| 111C000258 | 6,5 mm. |

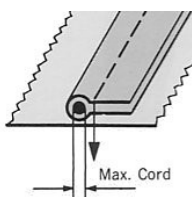
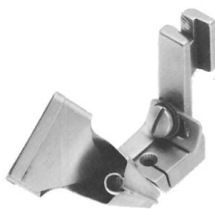

| Bordatore semplice con anima | | |
|------------------------------|---------------|--------------|
| Codice | Misura nastro | Misura anima |
| 111C000259 | 12 mm | 2 mm |
| 111C000260 | 14 mm | 2 mm |
| 111C000261 | 16 mm | 3 mm |
| 111C000262 | 18 mm | 3 mm |
| 111C000263 | 20 mm | 3 mm |
| 111C000264 | 22 mm | 3,5 mm |
| 111C000265 | 24 mm | 3,5 mm |
| 111C000266 | 26 mm | 3,5 mm |
| 111C000267 | 28 mm | 3,5 mm |
| 111C000268 | 32 mm | 3,5 mm |

PIEDINI A ROTELLA

PIEDINO A RULLI

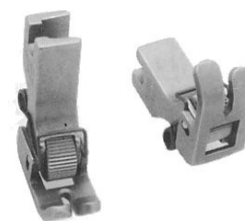

NECCHI
111C000493 30 mm

PFAFF
111C000496 22 mm
111C000497 26 mm

SINGER
111C000500 24 mm
111C000499 32 mm

111C000290

PIEDINI PER ORLATORI E BORDATORI

| Codice | Misura guida |
|------------|----------------|
| 111C000272 | 3/4" = 20 mm |
| 111C000273 | 7/8" = 22 mm |
| 111C000274 | 1" = 25 mm |
| 111C000275 | 1.1/8" = 30 mm |
| 111C000276 | 1.1/4" = 32 mm |
| 111C000277 | 1.1/2" = 38 mm |



111C000269
Rigido mm. 7



111C000270
Rigido mm. 9



Rigido



111C000271
Mobile mm. 6



111C000283
Fino a 10 mm
111C000284
Fino a 18 mm
111C000285
Oltre a 20 mm



111C000286
Fino a 10 mm
111C000287
Fino a 18 mm
111C000288
Oltre a 20 mm

COMPENSATORI PER BORDATORI



111C000278
da 3/4" a 7/8"
601



111C000279
da 1" a 1,1/8"
602



111C000280
da 1,1/4" a 2"
604



111C000281
da 6 mm. a 18 mm.
S543



111C000282
da 20 mm. a 24 mm.
S544

ACCESSORI PER PIEDINI

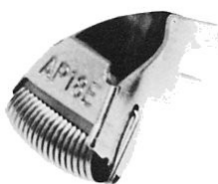

111C000306
Dispositivo taglia filo

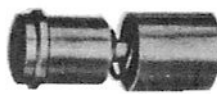

111C0SFC20
Dispositivo sgancio piedino



PIEDINI PIEGHETTATORI



111C000294
Modello normale G9

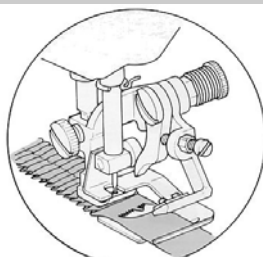

111C000295
Lamella

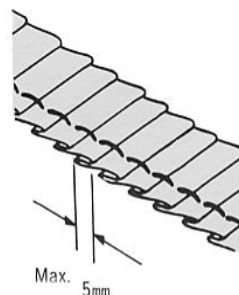

111C000296
Morsetto ago 7,24

111C000297
Morsetto ago 6,35





111C000299
Modello extra G900

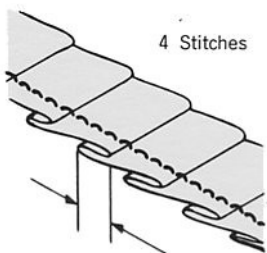

111C000270
Camme ricambio
4 punti

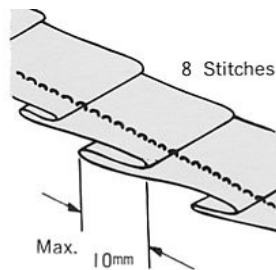

111C000271
Camme ricambio
8 punti

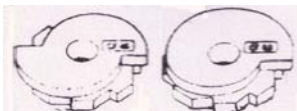

111C000302
Lamella 0,2 mm

111C000303
Lamella 0,5 mm





111C000304
Morsetto ago 7,24

111C000305
Morsetto ago 6,35

PIEDINI ADLER

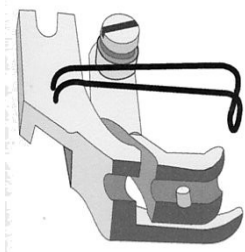
CL. 67, 68, 69, 167, 267



Per il montaggio del filetto 
Per la costruzione del filetto 

| Esterno | | | Interno | | |
|-------------------|-----------|--------|-------------------|-----------|--------|
| Codice | Originale | Misura | Codice | Originale | Misura |
| 111CA22145 | 067221453 | mm. 2 | 111CA22144 | 067221443 | mm. 2 |
| 111CA22074 | 067220743 | mm. 3 | 111CA22066 | 067220663 | mm. 3 |
| 111CA22075 | 067220753 | mm. 4 | 111CA22067 | 067220673 | mm. 4 |
| 111CA22076 | 067220763 | mm. 5 | 111CA22068 | 067220683 | mm. 5 |
| 111CA22077 | 067220773 | mm. 6 | 111CA22069 | 067220693 | mm. 6 |
| 111CA22127 | 067221273 | mm. 7 | 111CA22125 | 067221253 | mm. 7 |
| 111CA22128 | 067221283 | mm. 8 | 111CA22126 | 067221263 | mm. 8 |

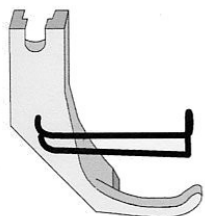

111CA02078
067 22 078 0
Esterno



111CA22071
067 22 071 3
Interno

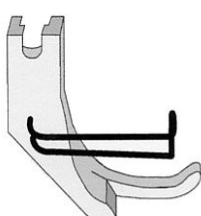

111CA02079
067 22 079 0
Esterno



111CA02070
067 22 070 0
Interno

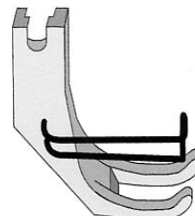

111CA22072
067 22 072 0
Esterno



111CA22063
067 22 063 3
Interno

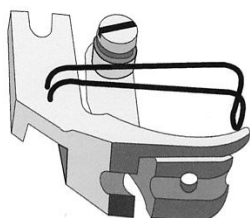

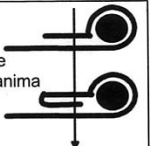
Per l'esecuzione di orlature con anima 

| Esterno | | | Interno | | |
|-------------------|-----------|--------|-------------------|-----------|--------|
| Codice | Originale | Misura | Codice | Originale | Misura |
| 111CA22146 | 067221463 | mm. 3 | 111CA22140 | 067221403 | mm. 3 |
| 111CA22147 | 067221473 | mm. 4 | 111CA22141 | 067221413 | mm. 4 |
| 111CA22148 | 067221483 | mm. 5 | 111CA22142 | 067221423 | mm. 5 |
| 111CA22149 | 067221493 | mm. 6 | 111CA22143 | 067221433 | mm. 6 |
| 111CA22156 | 067221563 | mm. 7 | 111CA22154 | 067221543 | mm. 7 |
| 111CA22157 | 067221573 | mm. 8 | 111CA22155 | 067221553 | mm. 8 |

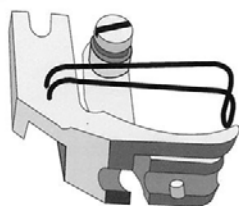

Per la produzione di
tracolle con anima interna



| Esterno | | | Interno | | |
|-------------------|-----------|--------|-------------------|-----------|--------|
| Codice | Originale | Misura | Codice | Originale | Misura |
| 111CA67E02 | 67E02 | mm. 2 | 111CA67I02 | 67I02 | mm. 2 |
| 111CA67E03 | 67E03 | mm. 3 | 111CA67I03 | 67I03 | mm. 3 |
| 111CA67E04 | 67E04 | mm. 4 | 111CA67I04 | 67I04 | mm. 4 |
| 111CA67E05 | 67E05 | mm. 5 | 111CA67I05 | 67I05 | mm. 5 |
| 111CA67E06 | 67E06 | mm. 6 | 111CA67I06 | 67I06 | mm. 6 |
| 111CA67E07 | 67E07 | mm. 7 | 111CA67I07 | 67I07 | mm. 7 |
| 111CA67E08 | 67E08 | mm. 8 | 111CA67I08 | 67I08 | mm. 8 |
| 111CA67E09 | 67E09 | mm. 9 | 111CA67I09 | 67I09 | mm. 9 |
| 111CA67E10 | 67E10 | mm. 10 | 111CA67I10 | 67I10 | mm. 10 |
| 111CA67E11 | 67E11 | mm. 11 | 111CA67I11 | 67I11 | mm. 11 |
| 111CA67E12 | 67E12 | mm. 12 | 111CA67I12 | 67I12 | mm. 12 |

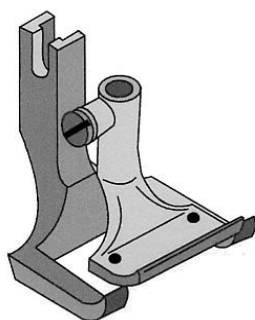

| Esterno | | | Interno | | |
|-------------------|-----------|--------|-------------------|-----------|--------|
| Codice | Originale | Misura | Codice | Originale | Misura |
| 111CA22250 | 067222503 | mm. 4 | 111CA22232 | 067222323 | mm. 4 |
| 111CA22251 | 067222513 | mm. 5 | 111CA22233 | 067222333 | mm. 5 |
| 111CA22252 | 067222523 | mm. 6 | 111CA22234 | 067222343 | mm. 6 |
| 111CA22254 | 067222543 | mm. 8 | 111CA22235 | 067222353 | mm. 8 |
| 111CA22256 | 067222563 | mm. 10 | 111CA22236 | 067222363 | mm. 10 |
| 111CA22257 | 067222573 | mm. 12 | 111CA22239 | 067222393 | mm. 12 |
| 111CA22259 | 067222593 | mm. 14 | 111CA22241 | 067222413 | mm. 14 |
| 111CA22260 | 067222603 | mm. 16 | 111CA22242 | 067222423 | mm. 16 |
| 111CA22261 | 067222613 | mm. 18 | 111CA22243 | 067222433 | mm. 18 |
| 111CA22262 | 067222623 | mm. 20 | 111CA22244 | 067222443 | mm. 20 |
| 111CA22278 | 067222783 | mm. 22 | 111CA22277 | 067222773 | mm. 22 |
| 111CA22263 | 067222633 | mm. 24 | 111CA22245 | 067222453 | mm. 24 |

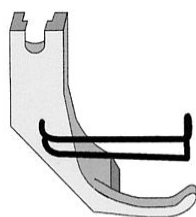

111CA00394
069 00 394 3
Esterno

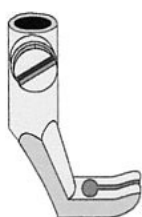

111CA22121
069 22 121 3
Interno

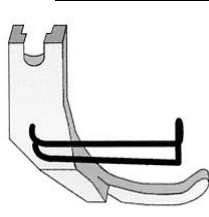

111CA22115
069 22 115 3
Esterno



111CA22113
069 22 113 3
Interno

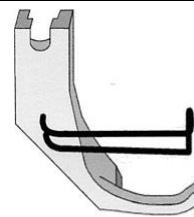

111CA22112
069 22 112 3
Esterno



111CA22114
069 22 144 3
Interno

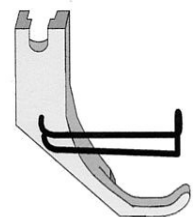

111C22116
069 22 116 3
Esterno



111CA22114
069 22 144 3
Interno

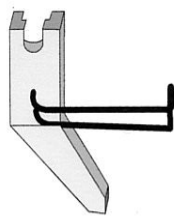

111CA0069G
69G
Per tracolle Esterno



111CA22113
069 22 113 3
Interno

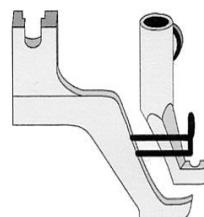

111CA02211
069 22 11
Coppia piedini per
fibbie

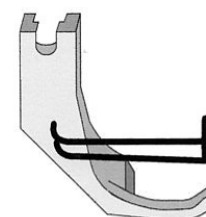

111CAF1310
F13/10
Per bordare Esterno

Suola corta per bordare



| Codice | Originale | Misure |
|-------------------|-----------|--------|
| 111CAA0502 | A0502 | mm. 2 |
| 111CAA0603 | A0603 | mm. 3 |
| 111CAA0704 | A0704 | mm. 4 |
| 111CAA0805 | A0805 | mm. 5 |
| 111CAA0906 | A0906 | mm. 6 |
| 111CAA1007 | A1007 | mm. 7 |
| 111CAA1108 | A1108 | mm. 8 |
| 111CAA1310 | A1310 | mm. 10 |

Suola lunga per bordare



| Codice | Originale | Misure |
|-------------------|-----------|--------|
| 111CAP0502 | P0502 | mm. 2 |
| 111CAP0603 | P0603 | mm. 3 |
| 111CAP0704 | P0704 | mm. 4 |
| 111CAP0805 | P0805 | mm. 5 |
| 111CAP0906 | P0906 | mm. 6 |
| 111CAP1007 | P1007 | mm. 7 |
| 111CAP1108 | P1108 | mm. 8 |
| 111CAP1310 | P1310 | mm. 10 |

Esterno

Interno

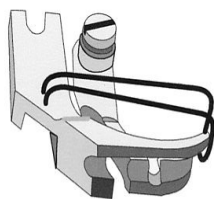

Per il montaggio del filetto
 Per la costruzione del filetto
 Per la produzione di tracolle con anima interna



| Codice | Originale | Misura | Codice | Originale | Misura |
|-------------------|-----------|---------|-------------------|-----------|---------|
| 111CA9ZP35 | 069ZP/35 | mm. 3,5 | 111CA9ZA35 | 069ZA/35 | mm. 3,5 |
| 111CA9ZP40 | 069ZP/40 | mm. 4,0 | 111CA9ZA40 | 069ZA/40 | mm. 4,0 |
| 111CA9ZP45 | 069ZP/45 | mm. 4,5 | 111CA9ZA45 | 069ZA/45 | mm. 4,5 |
| 111CA9ZP50 | 069ZP/50 | mm. 5,0 | 111CA9ZA50 | 069ZA/50 | mm. 5,0 |
| 111CA9ZP60 | 069ZP/60 | mm. 6,0 | 111CA9ZA60 | 069ZA/60 | mm. 6,0 |
| 111CA9ZP70 | 069ZP/70 | mm. 7,0 | 111CA9ZA70 | 069ZA/70 | mm. 7,0 |
| 111CA9ZP80 | 069ZP/80 | mm. 8,0 | 111CA9ZA80 | 069ZA/80 | mm. 8,0 |

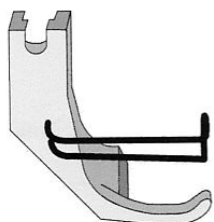

111CA00391
069 00 391 0
Esterno
Per bordare



111CA22117
069 00 117 3
Interno
Per bordare



111CA22100
069 00 100 3
Interno
Per bordare

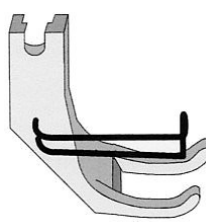

111CA12019
167 22 019 3
(167 22 019 0)
Esterno

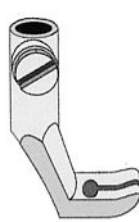

111CA12018
167 22 018 3
(167 22 018 0)
Interno

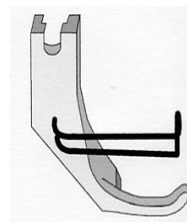

111CA1613
16-13
Esterno



Con guida interno
111CA67AG2 2
111CA67AG3 3
111CA67AG4 4
111CA67AG5 5
111CA67AG6 6
111CA67AG7 7
111CA67AG8 8

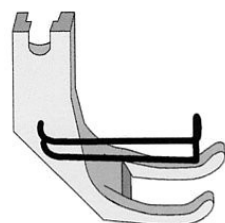

111CA22002
267 22 002 3
Esterno



111CA22001
267 22 001 3
Interno

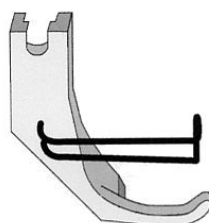

111CA22033
167 22 033 3
Esterno



111CA22032
167 22 032 3
Interno

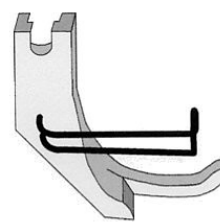

111CA22031
167 22 031 3
Esterno



111CA22030
167 22 030 3
Interno

CL 467, 767

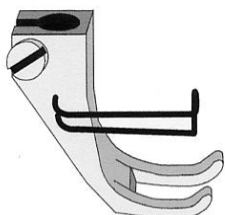

111CA000A6
A6 griffa mm 6
Esterno



111CA22063
067 22 063 3
Interno

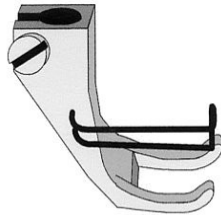

111CA000A8
A8 griffa mm 8
Esterno



111CA12018
167 22 018 3
Interno

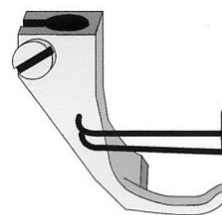

111CA000C6
C6 griffa mm 6
Esterno

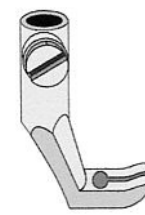

111CA22063
067 22 063 3
Interno



111CA000C8
C8 griffa mm 8
Esterno



111CA12018
167 22 018 3
Interno

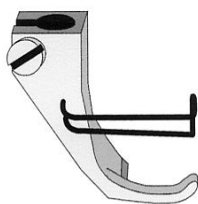

111CA000D6
D6 griffa mm 6
Esterno



111CA22071
067 22 071 3
Interno

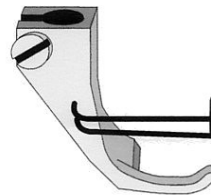

111CA000D8
D8 griffa mm 8
Esterno



111CA22032
167 22 032 3
Interno

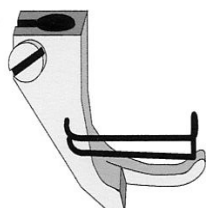

111CA000E6
E6 griffa mm 6 Esterno

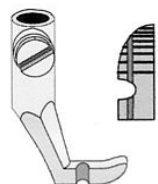

111CA02070
067 22 070 0 Interno



111CA000E8
E8 griffa mm 8 Esterno



111CA22030
167 22 030 3 Interno

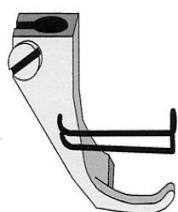

111CA000B6
Per bordare B6
griffa mm 6



| Codice | Originale | Misure |
|------------|-----------|--------|
| 111CAA0502 | A0502 | mm. 2 |
| 111CAA0603 | A0603 | mm. 3 |
| 111CAA0704 | A0704 | mm. 4 |
| 111CAA0805 | A0805 | mm. 5 |
| 111CAA0906 | A0906 | mm. 6 |
| 111CAA1007 | A1007 | mm. 7 |
| 111CAA1108 | A1108 | mm. 8 |
| 111CAA1310 | A1310 | mm. 10 |

Suola corta per bordare griffa mm.6



| Codice | Originale | Misure |
|------------|-----------|--------|
| 111CAP0502 | P0502 | mm. 2 |
| 111CAP0603 | P0603 | mm. 3 |
| 111CAP0704 | P0704 | mm. 4 |
| 111CAP0805 | P0805 | mm. 5 |
| 111CAP0906 | P0906 | mm. 6 |
| 111CAP1007 | P1007 | mm. 7 |
| 111CAP1108 | P1108 | mm. 8 |
| 111CAP1310 | P1310 | mm. 10 |

Suola lunga per bordare griffa mm.6

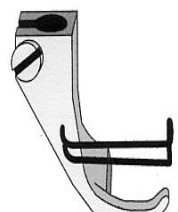

111CA000B8
Per bordare
B8 griffa mm 8



| Codice | Originale | Misure |
|------------|-----------|--------|
| 111CA19358 | 193//58 | mm. 4 |
| 111CA19359 | 193//59 | mm. 5 |
| 111CA19360 | 193//60 | mm. 6 |
| 111CA19361 | 193//61 | mm. 7 |
| 111CA19362 | 193//62 | mm. 8 |
| 111CA19363 | 193//63 | mm. 9 |

Suola corta per bordare griffa mm.8



| Codice | Originale | Misure |
|------------|-----------|--------|
| 111CA49358 | 493//58 | mm. 4 |
| 111CA49359 | 493//59 | mm. 5 |
| 111CA49360 | 493//60 | mm. 6 |
| 111CA49361 | 493//61 | mm. 7 |
| 111CA49362 | 493//62 | mm. 8 |
| 111CA49363 | 493//63 | mm. 9 |

Suola lunga per bordare griffa mm.8



Piedino ago destra griffa mm 8

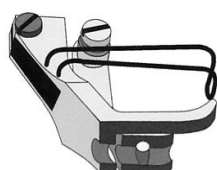
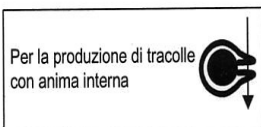

Piedino ago sinistra griffa mm 8

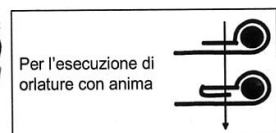

| Esterno | | | Interno | | |
|------------|-----------|--------|------------|-----------|--------|
| Codice | Originale | Misura | Codice | Originale | Misura |
| 111CA32231 | 367220313 | mm. 3 | 111CA22066 | 067220663 | mm. 3 |
| 111CA32211 | 367220113 | mm. 4 | 111CA22067 | 067220673 | mm. 4 |
| 111CA32212 | 367220123 | mm. 5 | 111CA22068 | 067220683 | mm. 5 |
| 111CA32213 | 367220133 | mm. 6 | 111CA22069 | 067220693 | mm. 6 |
| 111CA32232 | 367220323 | mm. 7 | 111CA22125 | 067221253 | mm. 7 |
| 111CA32233 | 367223333 | mm. 8 | 111CA22126 | 067221263 | mm. 8 |
| Esterno | | | Interno | | |
| Codice | Originale | Misura | Codice | Originale | Misura |
| 111CA32241 | 367220413 | mm. 4 | 111CA22141 | 367221413 | mm. 4 |
| 111CA32242 | 367220423 | mm. 5 | 111CA22142 | 367221423 | mm. 5 |
| 111CA32243 | 367220433 | mm. 6 | 111CA22143 | 367221433 | mm. 6 |
| 111CA32244 | 367220443 | mm. 7 | 111CA22154 | 367221543 | mm. 7 |
| 111CA32245 | 367220453 | mm. 8 | 111CA22155 | 367221553 | mm. 8 |

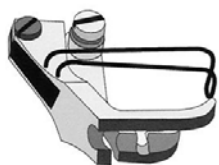

Per il montaggio del filetto

Per la costruzione del filetto



| Esterno | | | Interno | | |
|------------|-----------|---------|------------|-----------|---------|
| Codice | Originale | Misura | Codice | Originale | Misura |
| 111CA4ZP35 | 467ZP/35 | mm. 3,5 | 111CA9ZA35 | 069ZA/35 | mm. 3,5 |
| 111CA4ZP40 | 467ZP/40 | mm. 4,0 | 111CA9ZA40 | 069ZA/40 | mm. 4,0 |
| 111CA4ZP45 | 467ZP/45 | mm. 4,5 | 111CA9ZA45 | 069ZA/45 | mm. 4,5 |
| 111CA4ZP50 | 467ZP/50 | mm. 5,0 | 111CA9ZA50 | 069ZA/50 | mm. 5,0 |
| 111CA4ZP60 | 467ZP/60 | mm. 6,0 | 111CA9ZA60 | 069ZA/60 | mm. 6,0 |
| 111CA4ZP70 | 467ZP/70 | mm. 7,0 | 111CA9ZA70 | 069ZA/70 | mm. 7,0 |
| 111CA4ZP80 | 467ZP/80 | mm. 8,0 | 111CA9ZA80 | 069ZA/80 | mm. 8,0 |

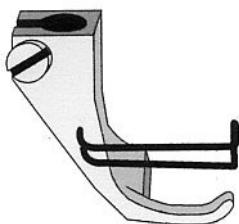

111CA000B8
Per bordare B8
griffa mm 8



Con guida interno

| Codice | Misura |
|------------|--------|
| 111CA67AG2 | mm. 2 |
| 111CA67AG3 | mm. 3 |
| 111CA67AG4 | mm. 4 |
| 111CA67AG5 | mm. 5 |
| 111CA67AG6 | mm. 6 |
| 111CA67AG7 | mm. 7 |
| 111CA67AG8 | mm. 8 |

CL. 67, 68, 69, 167, 267 CORDONATORI



Scanalato destro esterno



Scanalato ago a destra interno

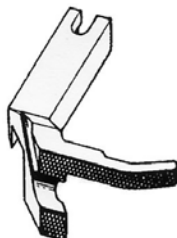

Scanalato destro esterno

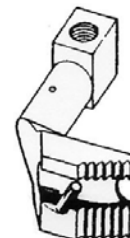

Scanalato ago a destra interno

| Codice | Misura | Codice | Misura | Codice | Misura | Codice | Misura |
|------------|--------|------------|--------|------------|--------|------------|--------|
| 111CAE1D02 | mm. 2 | 111CAADD02 | mm. 2 | 111CAE1D02 | mm. 2 | 111CABDD02 | mm. 2 |
| 111CAE1D03 | mm. 3 | 111CAADD03 | mm. 3 | 111CAE1D03 | mm. 3 | 111CABDD03 | mm. 3 |
| 111CAE1D04 | mm. 4 | 111CAADD04 | mm. 4 | 111CAE1D04 | mm. 4 | 111CABDD04 | mm. 4 |
| 111CAE1D05 | mm. 5 | 111CAADD05 | mm. 5 | 111CAE1D05 | mm. 5 | 111CABDD05 | mm. 5 |
| 111CAE1D06 | mm. 6 | 111CAADD06 | mm. 6 | 111CAE1D06 | mm. 6 | 111CABDD06 | mm. 6 |
| 111CAE1D07 | mm. 7 | 111CAADD07 | mm. 7 | 111CAE1D07 | mm. 7 | 111CABDD07 | mm. 7 |
| 111CAE1D08 | mm. 8 | 111CAADD08 | mm. 8 | 111CAE1D08 | mm. 8 | 111CABDD08 | mm. 8 |
| 111CAE1D09 | mm. 9 | 111CAADD09 | mm. 9 | 111CAE1D09 | mm. 9 | 111CABDD09 | mm. 9 |
| 111CAE1D10 | mm. 10 | 111CAADD10 | mm. 10 | 111CAE1D10 | mm. 10 | 111CABDD10 | mm. 10 |
| 111CAE1D11 | mm. 11 | 111CAADD11 | mm. 11 | 111CAE1D11 | mm. 11 | 111CABDD11 | mm. 11 |
| 111CAE1D12 | mm. 12 | 111CAADD12 | mm. 12 | 111CAE1D12 | mm. 12 | 111CABDD12 | mm. 12 |

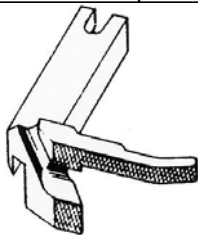

Scanalato destro esterno



Scanalato ago a destra interno

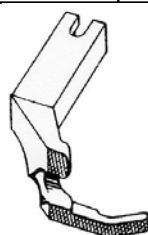

Scanalato sinistro esterno

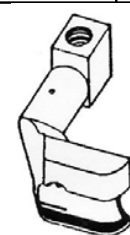

Scanalato ago a sinistra interno

| Codice | Misura | Codice | Misura | Codice | Misura | Codice | Misura |
|------------|--------|------------|--------|------------|--------|------------|--------|
| 111CAE2D02 | mm. 2 | 111CACDL02 | mm. 2 | 111CAE4S02 | mm. 2 | 111CAESL02 | mm. 2 |
| 111CAE2D03 | mm. 3 | 111CACDL03 | mm. 3 | 111CAE4S03 | mm. 3 | 111CAESL03 | mm. 3 |
| 111CAE2D04 | mm. 4 | 111CACDL04 | mm. 4 | 111CAE4S04 | mm. 4 | 111CAESL04 | mm. 4 |
| 111CAE2D05 | mm. 5 | 111CACDL05 | mm. 5 | 111CAE4S05 | mm. 5 | 111CAESL05 | mm. 5 |
| 111CAE2D06 | mm. 6 | 111CACDL06 | mm. 6 | 111CAE4S06 | mm. 6 | 111CAESL06 | mm. 6 |
| 111CAE2D07 | mm. 7 | 111CACDL07 | mm. 7 | 111CAE4S07 | mm. 7 | 111CAESL07 | mm. 7 |
| 111CAE2D08 | mm. 8 | 111CACDL08 | mm. 8 | 111CAE4S08 | mm. 8 | 111CAESL08 | mm. 8 |
| 111CAE2D09 | mm. 9 | 111CACDL09 | mm. 9 | 111CAE4S09 | mm. 9 | 111CAESL09 | mm. 9 |
| 111CAE2D10 | mm. 10 | 111CACDL10 | mm. 10 | 111CAE4S10 | mm. 10 | 111CAESL10 | mm. 10 |
| 111CAE2D11 | mm. 11 | 111CACDL11 | mm. 11 | 111CAE4S11 | mm. 11 | 111CAESL11 | mm. 11 |
| 111CAE2D12 | mm. 12 | 111CACDL12 | mm. 12 | 111CAE4S12 | mm. 12 | 111CAESL12 | mm. 12 |

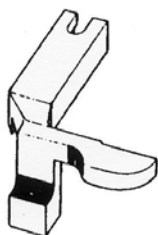

Sagomato destro esterno



Sagomato ago a destra interno

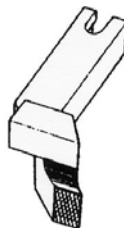

Sagomato destro esterno



Sagomato ago a destra interno

| Codice | Misura | Codice | Misura | Codice | Misura | Codice | Misura |
|-------------------|--------|-------------------|--------|-------------------|--------|-------------------|--------|
| 111CAE6D03 | mm. 3 | 111CAGDL03 | mm. 3 | 111CAE7D03 | mm. 3 | 111CAHDL03 | mm. 3 |
| 111CAE6D04 | mm. 4 | 111CAGDL04 | mm. 4 | 111CAE7D04 | mm. 4 | 111CAHDL04 | mm. 4 |
| 111CAE6D05 | mm. 5 | 111CAGDL05 | mm. 5 | 111CAE7D05 | mm. 5 | 111CAHDL05 | mm. 5 |
| 111CAE6D06 | mm. 6 | 111CAGDL06 | mm. 6 | 111CAE7D06 | mm. 6 | 111CAHDL06 | mm. 6 |
| 111CAE6D07 | mm. 7 | 111CAGDL07 | mm. 7 | 111CAE7D07 | mm. 7 | 111CAHDL07 | mm. 7 |

PIEDINI A BILANCINO PER ADLER

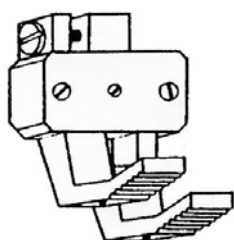

BASSI (2 VITI FRONTE)

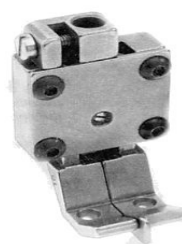

ALTI (4 VITI FRONTE)

| Dentato | | Liscio | | Con Guida centrale | |
|-------------------|----------|-------------------|----------|--------------------|----------|
| ALTO | | ALTO | | ALTO | |
| Codice | Misura | Codice | Misura | Codice | Misura |
| 111CABID48 | mm. 4,8 | 111CABIL48 | mm. 4,8 | 111CBIC048 | mm. 4,8 |
| 111CABID60 | mm. 6,0 | 111CABIL60 | mm. 6,0 | 111CBIC060 | mm. 6,0 |
| 111CABID64 | mm. 6,4 | 111CABIL64 | mm. 6,4 | 111CBIC064 | mm. 6,4 |
| 111CABID80 | mm. 8,0 | 111CABIL80 | mm. 8,0 | 111CBIC080 | mm. 8,0 |
| 111CABID10 | mm. 10,0 | 111CABIL10 | mm. 10,0 | 111CBIC100 | mm. 10,0 |
| BASSO | | BASSO | | BASSO | |
| 111CABBD48 | mm. 4,8 | 111CABBL48 | mm. 4,8 | 111CBBC048 | mm. 4,8 |
| 111CABBD60 | mm. 6,0 | 111CABBL60 | mm. 6,0 | 111CBBC060 | mm. 6,0 |
| 111CABBD64 | mm. 6,4 | 111CABBL64 | mm. 6,4 | 111CBBC064 | mm. 6,4 |
| 111CABBD80 | mm. 8,0 | 111CABBL80 | mm. 8,0 | 111CBBC080 | mm. 8,0 |
| 111CABBD10 | mm. 10,0 | 111CABBL10 | mm. 10,0 | 111CBBC100 | mm. 10,0 |

MISURE SUPPLEMENTARI PIEDINO A BILANCINO ALTO CON GUIDA CENTRALE PER ADLER 268

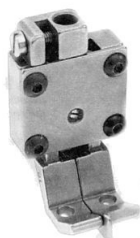

| Codice | Misura |
|-------------------|----------|
| 111CBIC120 | mm. 12,0 |
| 111CBIC140 | mm. 14,0 |
| 111CBIC160 | mm. 16,0 |

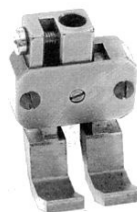

Piedino a bilancino doppio

111CBID010 mm. 1
111CBID020 mm. 2

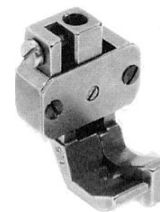

Piedino bilancino destro

111CBIDS10 mm. 1,0
111CBIDS15 mm. 1,5
111CBIDS25 mm. 2,5

PIEDINI PER DURKOPP

CL. 211, 212

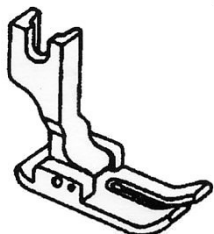

111CD20478
CL. 211 204-78



111CD11748
CL. 211 211-748

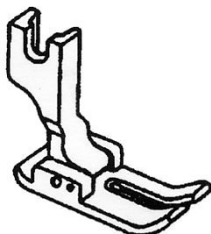

111CD20452
CL. 211 204-52

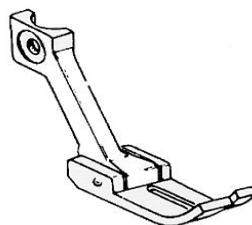

111CD22903
CL. 212 212-2903

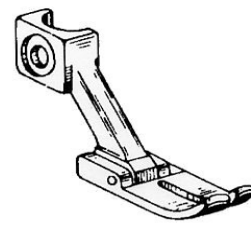

111CD21193
CL. 212 212-1193

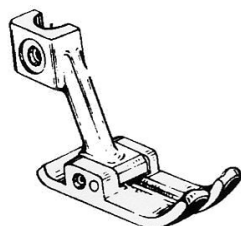

111CD21643
Largo
CL. 212 212-1643

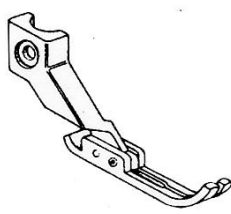

111CD22013
Stretto
CL. 212 212-2013

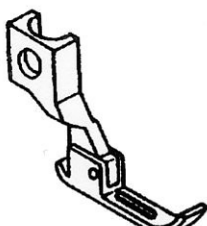

111CD2CC54
Piedino cern. mm.5,4
111CD2CC70
Piedino cern. mm. 7

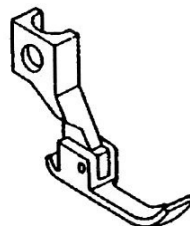

111CD2CD54
Piedino cern. dx mm.5,4
111CD2CD70
Piedino cern. dx mm. 7

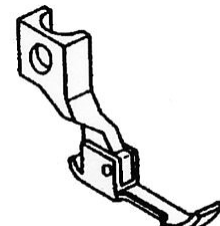

111CD2CS54
Piedino cern. sx mm.5,4
111CD2CS70
Piedino cern. sx mm. 7



111CD2CREG
Piedino cerniera
regolabile



111CD2518F
Piedino cerniera
invisibile



111CD2518N
Piedino cerniere
invisibili con indice



111CD12887
212-887



111CD200TE
Piedino teflon



111CD200TB
Ciabatta di ricambio

COMPENSATORI



| Destro right | |
|-------------------|-------------|
| 111CD2D032 | 1/32" = 0,8 |
| 111CD2D016 | 1/16" = 1,6 |
| 111CD2D008 | 1/8" = 3,2 |
| 111CD2D316 | 3/16" = 4,8 |
| 111CD2D004 | .1/4" = 6,4 |
| Sinistro left | |
| 111CD2S032 | 1/32" = 0,8 |
| 111CD2S016 | 1/16" = 1,6 |
| 111CD2S008 | 1/8" = 3,2 |
| 111CD2S316 | 3/16" = 4,8 |
| 111CD2S004 | .1/4" = 6,4 |
| Doppio dual | |
| 111CD2DOPP | |

cl. 244

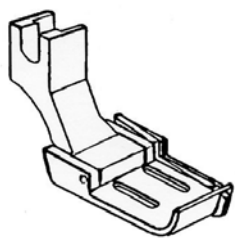

111CD24D48
Piedino 2 aghi mm. 4,8
Con guida destra a mm. 2
111CD24D64
Piedino 2 aghi mm. 6,4
Con guida destra a mm. 2

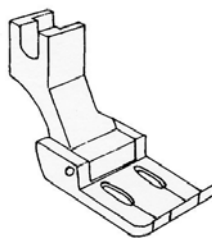

111CD24448
Piedino 2 aghi mm. 4,8

111CD24464
Piedino 2 aghi mm. 6,4

cl. 272

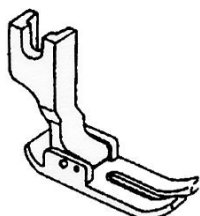

111CD76801
Normale
272-6801

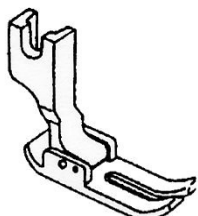

111CD76807
Largo 272-6807



111CD7351N
S351 NF

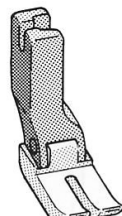

111CD700TE
Piedino teflon



111CD700TB
Ciabatta di ricambio



111CD7CREG
Piedino cerniera
regolabile

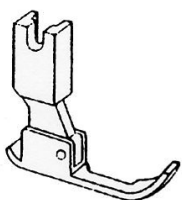

111CD7CD54
Cerniera dx mm.5,4
111CD7CD70
Cerniera dx mm. 7

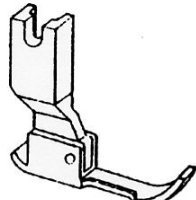

111CD7CS54
Cerniera sx mm.5,4
111CD7CS70
Cerniera sx mm. 7



111CD7CC54
Piedino cerniera mm.5,4
111CD7CC70
Piedino cerniera mm. 7



111CD7363V
Piedino cerniera
ciabatta rialzata



111CD7361N
Piedino cerniera
destro



111CD7360N
Piedino cerniera
sinistro



111CD7518N
Piedino cerniere
invisibili con indice



111CD7518F
Piedino cerniera
invisibile

COMPENSATORI

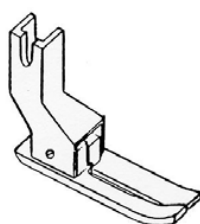

| Destro | | Doppio Dual | |
|-------------------|-----------|-------------------|------------|
| 111CPD1132 | 1/32"=0,8 | 111CPP1132 | 1/32"=0,8 |
| 111CPD1116 | 1/16"=1,6 | 111CPP1116 | 1/16"=1,6 |
| 111CPD1018 | 1/8" =3,2 | | |
| 111CPD1316 | 3/16"=4,8 | | |
| 111CPD1014 | 1/4" =6,4 | Sinistro Left | |
| 111CPD1072 | mm. 7,2 | 111CPS1132 | 1/32"=0,8 |
| 111CPD1080 | mm. 8,0 | 111CPS1116 | 1/16"=1,6 |
| 111CPD1090 | mm. 9,0 | 111CPS1018 | 1/8" =3,2 |
| 111CPD1100 | mm. 10 | 111CPS1316 | 3/16"=4,8 |
| 111CPD1127 | mm. 12,7 | 111CPS1014 | .1/4" =6,4 |
| 111CPD1140 | mm. 14 | | |
| 111CPD1160 | mm. 16 | | |
| 111CPD1180 | mm. 18 | | |

PIEDINI PER JUKI



111CJB0120
B1524 012 OB0



111CJB012A
B1524 012 OA0



111CJB012B
B1524 012 BBA



111CJB041A
B1524 041 EA0



111CJB4120
B1524 412 OB0



111CJB543B
B1511 543 BBA

cl. MS 19



110CJ7019D
B1507 019 DAO
3/16

110CJ7019F
B1507 019 FAO
1/4

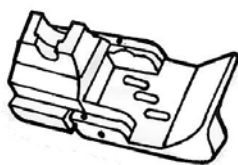

110CJ7026F
B1507 026 FAO 1/4"
cl. MS 26

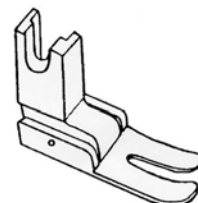

111CJD415B
D1524 415 BAA
cl. DLN-5410

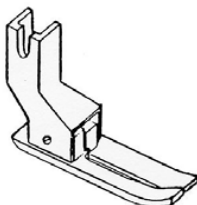

Compensatore
DLN-5410
9010SS

| Destro Right | | Doppio Dual | |
|-------------------|-----------|-------------------|-----------|
| 111CPD1132 | 1/32"=0,8 | 111CPP1132 | 1/32"=0,8 |
| 111CPD1116 | 1/16"=1,6 | 111CPP1116 | 1/16"=1,6 |
| 111CPD1018 | 1/8" =3,2 | | |
| 111CPD1316 | 3/16"=4,8 | | |
| 111CPD1014 | 1/4" =6,4 | | |
| | | Sinistro Left | |
| 111CPD1072 | mm. 7,2 | 111CPS1132 | 1/32"=0,8 |
| 111CPD1080 | mm. 8,0 | 111CPS1116 | 1/16"=1,6 |
| 111CPD1090 | mm. 9,0 | 111CPS1018 | 1/8" =3,2 |
| 111CPD1100 | mm. 10 | 111CPS1316 | 3/16"=4,8 |
| 111CPD1127 | mm. 12,7 | 111CPS1014 | 1/4" =6,4 |
| 111CPD1140 | mm. 14 | | |
| 111CPD1160 | mm. 16 | | |
| 111CPD1180 | mm. 18 | | |

PIEDINI PER NECCHI



111CN10409
110409-3-00
cl. 720



111CN56099
956099-3-00
cl. 750

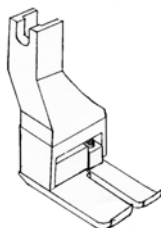

Piedino
compensatore
cl. 831, 901

| Destro | |
|-------------------|----------|
| 111CN83D01 | 1.0 mm. |
| 111CN83D15 | 1.5 mm. |
| 111CN83D03 | 3.0 mm. |
| 111CN83D48 | 4.8 mm. |
| 111CN83D64 | 6.4 mm. |
| 111CN83D07 | 7.0 mm. |
| 111CN83D08 | 8.0 mm. |
| 111CN83D10 | 10,0 mm. |
| Sinistro | |
| 111CN83S01 | 1.0 mm. |
| 111CN83S15 | 1.5 mm. |
| 111CN83S03 | 3.0 mm. |

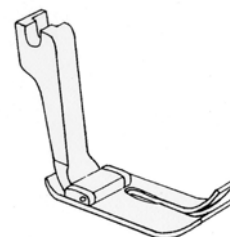

111CN46409
146409-3-00
cl. 831



111CN56332
956332-3-00
cl. 831

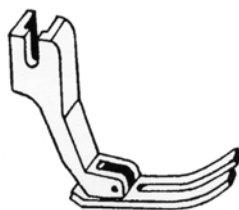

111CN3STCE
Stretto per cerniera
cl. 831

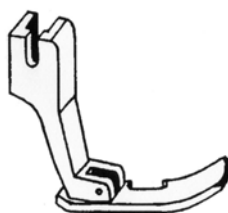

111CN3STDS
Stretto destro per cerniera
cl. 831

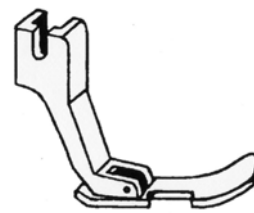

111CN3STSN
Stretto sinistro per cerniera
cl. 831

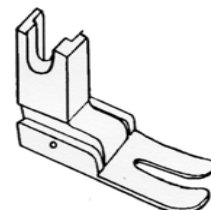

111CN56378
956378-3-01
cl. 830, 835

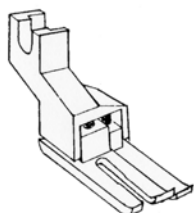

Piedino compensatore
cl. 881

| Destro Right | |
|-------------------|--------|
| 111CN88D01 | 1.0 mm |
| 111CN88D15 | 1.5 mm |
| 111CN88D03 | 3.0 mm |
| 111CN88D48 | 4.8 mm |
| 111CN88D64 | 6.4 mm |
| Sinistro Left | |
| 111CN88S01 | 1.0 mm |
| 111CN88S15 | 1.5 mm |
| 111CN88S03 | 3,0 mm |

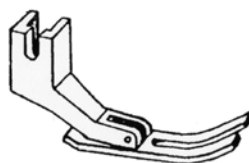

111CN8STCE
Stretto per cerniera
cl. 881

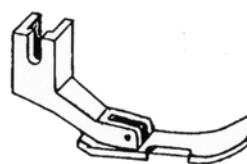

111CN8STSN
Stretto sinistro per cerniera
cl. 881

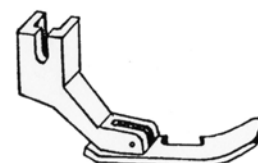

111CN8STDS
Stretto destro per cerniera
cl. 881



111CN61789
961789-3-00
Stretto cl. 881



111CN61761
961761-3-00
Normale cl. 881



111CN61788
961788-3-00
Largo cl. 881



111CD7CREG
Piedino cerniera regolabile
cl. 881

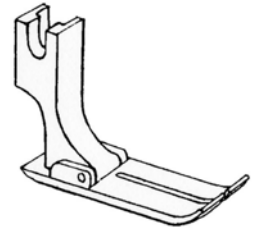

111CN56653
956653-3-00
cl. 885

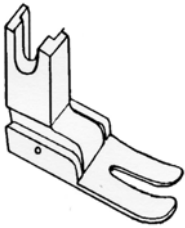

111CN56378
956378-3-00
cl. 885

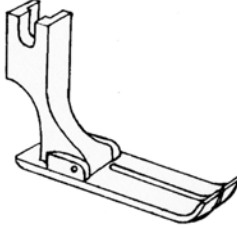

111CN56517
956517-3-00
cl. 885



111CN90315
90315
cl. 840-134, 902-100

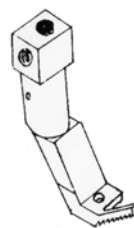

111CN90330
90330
cl. 840-134, 902-100

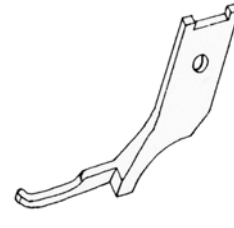

111CN56521
956521
cl. 840-130

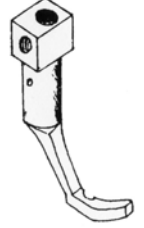

111CN56520
956520
cl. 840-130



111CN90315
90315
cl. 840-134,
902-100



111CN09639
109639
cl. 840-134,
902-100

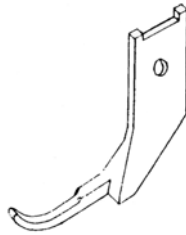

111CND6523
956523-D
cl. 840-134
Ago destra

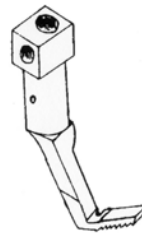

111CND6522
956522-D
cl. 840-134
Ago destra

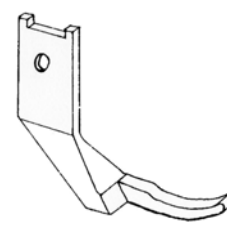

111CNS6523
956523-S
cl. 840-134
Ago sinistra

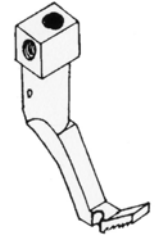

111CNS6522
956522-S
cl. 840-134
Ago destra

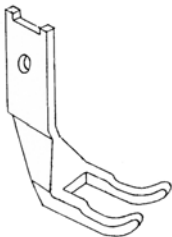

111CN55409
155409
cl. 902-155

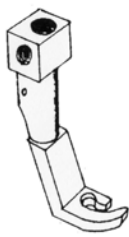

111CN55639
155639
cl. 902-155

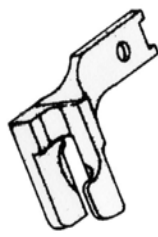

Scanalato esterno ago destra 49544
cl. 840, 902

| Codice | Misura |
|-------------------|--------|
| 111CP54418 | 1/8" |
| 111CP54452 | 5/32" |
| 111CP54436 | 3/16" |
| 111CP54414 | .1/4" |
| 111CP54456 | 5/16" |
| 111CP54438 | 3/8" |



Scanalato interno ago destra 49047
cl. 840, 902

| Codice | Misura |
|-------------------|--------|
| 111CP04718 | 1/8" |
| 111CP04752 | 5/32" |
| 111CP04736 | 3/16" |
| 111CP04714 | .1/4" |
| 111CP04756 | 5/16" |
| 111CP04738 | 3/8" |

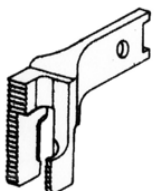

| Codice | Misura |
|-------------------|--------|
| 111CP54T18 | 1/8" |
| 111CP54T52 | 5/32" |
| 111CP54T36 | 3/16" |
| 111CP54T14 | .1/4" |
| 111CP54T56 | 5/16" |
| 111CP54T38 | 3/8" |

Scanalato esterno ago destra 49544T
cl. 840, 902



Scanalato interno ago destra 49047T
cl. 840, 902

| Codice | Misura |
|-------------------|--------|
| 111CP04T18 | 1/8" |
| 111CP04T52 | 5/32" |
| 111CP04T36 | 3/16" |
| 111CP04T14 | .1/4" |
| 111CP04T56 | 5/16" |
| 111CP04T38 | 3/8" |

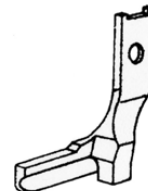

Scanalato esterno ago
destra 42443
cl. 840, 902
111CP44336 3/16"
111CP44314 .1/4"

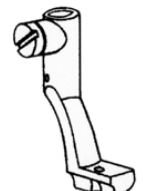

Scanalato interno ago
destra 42442
cl. 840, 902
111CP44236 3/16"
111CP44214 .1/4"

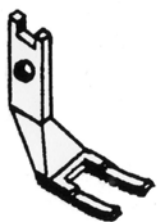

111CN56208
956208
cl. 840, 902



111CN56207
956207
cl. 840, 902

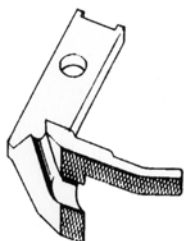

Scanalato destro esterno



Scanalato ago a destra interno

| Codice | Misura |
|------------|--------|
| 111CNE1D02 | mm. 2 |
| 111CNE1D03 | mm. 3 |
| 111CNE1D04 | mm. 4 |
| 111CNE1D05 | mm. 5 |
| 111CNE1D06 | mm. 6 |
| 111CNE1D07 | mm. 7 |
| 111CNE1D08 | mm. 8 |
| 111CNE1D09 | mm. 9 |
| 111CNE1D10 | mm. 10 |
| 111CNE1D11 | mm. 11 |
| 111CNE1D12 | mm. 12 |

| Codice | Misura |
|------------|--------|
| 111CAADD02 | mm. 2 |
| 111CAADD03 | mm. 3 |
| 111CAADD04 | mm. 4 |
| 111CAADD05 | mm. 5 |
| 111CAADD06 | mm. 6 |
| 111CAADD07 | mm. 7 |
| 111CAADD08 | mm. 8 |
| 111CAADD09 | mm. 9 |
| 111CAADD10 | mm. 10 |
| 111CAADD11 | mm. 11 |
| 111CAADD12 | mm. 12 |

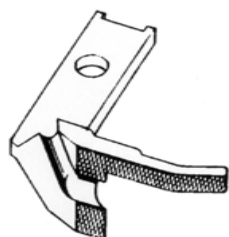

Scanalato destro esterno

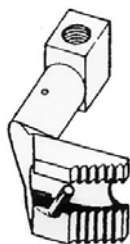

Scanalato ago a destra interno

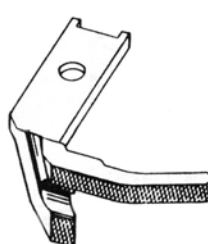

Scanalato destro esterno



Scanalato ago a destra interno

| Codice | Misura | Codice | Misura | Codice | Misura | Codice | Misura |
|------------|--------|------------|--------|------------|--------|------------|--------|
| 111CNE1D02 | mm. 2 | 111CABDD02 | mm. 2 | 111CNE2D02 | mm. 2 | 111CACDL02 | mm. 2 |
| 111CNE1D03 | mm. 3 | 111CABDD03 | mm. 3 | 111CNE2D03 | mm. 3 | 111CACDL03 | mm. 3 |
| 111CNE1D04 | mm. 4 | 111CABDD04 | mm. 4 | 111CNE2D04 | mm. 4 | 111CACDL04 | mm. 4 |
| 111CNE1D05 | mm. 5 | 111CABDD05 | mm. 5 | 111CNE2D05 | mm. 5 | 111CACDL05 | mm. 5 |
| 111CNE1D06 | mm. 6 | 111CABDD06 | mm. 6 | 111CNE2D06 | mm. 6 | 111CACDL06 | mm. 6 |
| 111CNE1D07 | mm. 7 | 111CABDD07 | mm. 7 | 111CNE2D07 | mm. 7 | 111CACDL07 | mm. 7 |
| 111CNE1D08 | mm. 8 | 111CABDD08 | mm. 8 | 111CNE2D08 | mm. 8 | 111CACDL08 | mm. 8 |
| 111CNE1D09 | mm. 9 | 111CABDD09 | mm. 9 | 111CNE2D09 | mm. 9 | 111CACDL09 | mm. 9 |
| 111CNE1D10 | mm. 10 | 111CABDD10 | mm. 10 | 111CNE2D10 | mm. 10 | 111CACDL10 | mm. 10 |
| 111CNE1D11 | mm. 11 | 111CABDD11 | mm. 11 | 111CNE2D11 | mm. 11 | 111CACDL11 | mm. 11 |
| 111CNE1D12 | mm. 12 | 111CABDD12 | mm. 12 | 111CNE2D12 | mm. 12 | 111CACDL12 | mm. 12 |

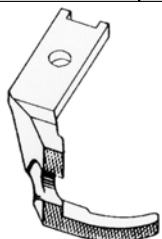

Scanalato sinistro esterno



Scanalato ago a sinistra interno

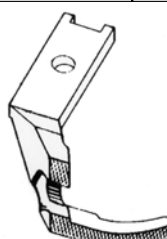

Scanalato sinistro esterno



Scanalato ago a sinistra interno

| Codice | Misura | Codice | Misura | Codice | Misura | Codice | Misura |
|------------|--------|------------|--------|------------|--------|------------|--------|
| 111CNE4S02 | mm. 2 | 111CAESL02 | mm. 2 | 111CNE5S02 | mm. 2 | 111CAFSD02 | mm. 2 |
| 111CNE4S03 | mm. 3 | 111CAESL03 | mm. 3 | 111CNE5S03 | mm. 3 | 111CAFSD03 | mm. 3 |
| 111CNE4S04 | mm. 4 | 111CAESL04 | mm. 4 | 111CNE5S04 | mm. 4 | 111CAFSD04 | mm. 4 |
| 111CNE4S05 | mm. 5 | 111CAESL05 | mm. 5 | 111CNE5S05 | mm. 5 | 111CAFSD05 | mm. 5 |
| 111CNE4S06 | mm. 6 | 111CAESL06 | mm. 6 | 111CNE5S06 | mm. 6 | 111CAFSD06 | mm. 6 |
| 111CNE4S07 | mm. 7 | 111CAESL07 | mm. 7 | 111CNE5S07 | mm. 7 | 111CAFSD07 | mm. 7 |
| 111CNE4S08 | mm. 8 | 111CAESL08 | mm. 8 | 111CNE5S08 | mm. 8 | 111CAFSD08 | mm. 8 |
| 111CNE4S09 | mm. 9 | 111CAESL09 | mm. 9 | 111CNE5S09 | mm. 9 | 111CAFSD09 | mm. 9 |
| 111CNE4S10 | mm. 10 | 111CAESL10 | mm. 10 | 111CNE5S10 | mm. 10 | 111CAFSD10 | mm. 10 |
| 111CNE4S11 | mm. 11 | 111CAESL11 | mm. 11 | 111CNE5S11 | mm. 11 | 111CAFSD11 | mm. 11 |
| 111CNE4S12 | mm. 12 | 111CAESL12 | mm. 12 | 111CNE5S12 | mm. 12 | 111CAFSD12 | mm. 12 |

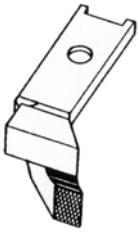

Sagomato destro esterno

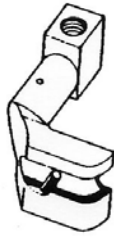

Sagomato ago a destra interno

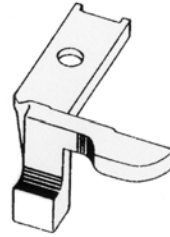

Sagomato destro esterno



Sagomato ago a destra interno

| Codice | Misura | Codice | Misura | Codice | Misura | Codice | Misura |
|-------------------|--------|-------------------|--------|-------------------|--------|-------------------|--------|
| 111CNE7D03 | mm. 3 | 111CAHDL03 | mm. 3 | 111CNE6D03 | mm. 3 | 111CAGDL03 | mm. 3 |
| 111CNE7D04 | mm. 4 | 111CAHDL04 | mm. 4 | 111CNE6D04 | mm. 4 | 111CAGDL04 | mm. 4 |
| 111CNE7D05 | mm. 5 | 111CAHDL05 | mm. 5 | 111CNE6D05 | mm. 5 | 111CAGDL05 | mm. 5 |
| 111CNE7D06 | mm. 6 | 111CAHDL06 | mm. 6 | 111CNE6D06 | mm. 6 | 111CAGDL06 | mm. 6 |
| 111CNE7D07 | mm. 7 | 111CAHDL07 | mm. 7 | 111CNE6D07 | mm. 7 | 111CAGDL07 | mm. 7 |

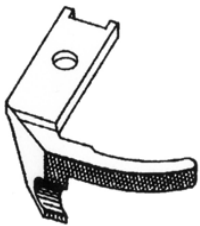

Sagomato destro esterno



Sagomato ago a sinistra interno



Sagomato sinistro esterno



Sagomato ago a destra interno

| Codice | Misura | Codice | Misura | Codice | Misura | Codice | Misura |
|-------------------|--------|------------------|--------|-------------------|--------|-------------------|--------|
| 111CNE3D02 | mm. 2 | 111CADD02 | mm. 2 | 111CNE8D02 | mm. 2 | 111CAIDD02 | Mm. 2 |
| 111CNE3D03 | mm. 3 | 111CADD03 | mm. 3 | 111CNE8D08 | mm. 3 | 111CAIDD03 | Mm. 3 |
| 111CNE3D04 | mm. 4 | 111CADD04 | mm. 4 | 111CNE8D04 | mm. 4 | 111CAIDD04 | Mm. 4 |
| 111CNE3D05 | mm. 5 | 111CADD05 | mm. 5 | 111CNE8D05 | mm. 5 | 111CAIDD05 | Mm. 5 |
| 111CNE3D06 | mm. 6 | 111CADD06 | mm. 6 | 111CNE8D06 | mm. 6 | 111CAIDD06 | Mm. 6 |
| 111CNE3D03 | mm. 7 | 111CADD03 | mm. 7 | 111CNE8D08 | mm. 7 | 111CAIDD03 | Mm. 7 |
| 111CNE3D08 | mm. 8 | 111CADD08 | mm. 8 | 111CNE8D08 | mm. 8 | 111CAIDD08 | Mm. 8 |

PIEDINI A BILANCINO

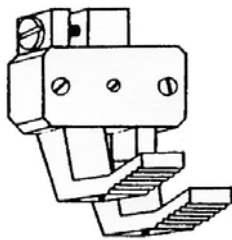

BASSI (2 VITI FRONTE)

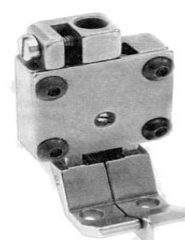

ALTI (4 VITI FRONTE)

| Dentato | | Liscio | | Con Guida centrale | |
|-------------------|----------|-------------------|----------|---------------------------|----------|
| ALTO | | ALTO | | ALTO | |
| Codice | Misura | Codice | Misura | Codice | Misura |
| 111CABID48 | mm. 4,8 | 111CABIL48 | mm. 4,8 | 111CBIC048 | mm. 4,8 |
| 111CABID60 | mm. 6,0 | 111CABIL60 | mm. 6,0 | 111CBIC060 | mm. 6,0 |
| 111CABID64 | mm. 6,4 | 111CABIL64 | mm. 6,4 | 111CBIC064 | mm. 6,4 |
| 111CABID80 | mm. 8,0 | 111CABIL80 | mm. 8,0 | 111CBIC080 | mm. 8,0 |
| 111CABID10 | mm. 10,0 | 111CABIL10 | mm. 10,0 | 111CBIC100 | mm. 10,0 |
| BASSO | | BASSO | | BASSO | |
| 111CABBD48 | mm. 4,8 | 111CABBL48 | mm. 4,8 | 111CBBC048 | mm. 4,8 |
| 111CABBD60 | mm. 6,0 | 111CABBL60 | mm. 6,0 | 111CBBC060 | mm. 6,0 |
| 111CABBD64 | mm. 6,4 | 111CABBL64 | mm. 6,4 | 111CBBC064 | mm. 6,4 |
| 111CABBD80 | mm. 8,0 | 111CABBL80 | mm. 8,0 | 111CBBC080 | mm. 8,0 |
| 111CABBD10 | mm. 10,0 | 111CABBL10 | mm. 10,0 | 111CBBC100 | mm. 10,0 |

| ALTO | |
|-------------------|----------|
| Codice | Misura |
| 111CNBIA48 | mm. 4,8 |
| 111CNBIA60 | mm. 6,0 |
| 111CNBIA64 | mm. 6,4 |
| 111CNBIA80 | mm. 8,0 |
| 111CNBIA10 | mm. 10,0 |
| 111CNBIA12 | mm. 12,0 |
| BASSO | |
| 111CNBIB48 | mm. 4,8 |
| 111CNBIB60 | mm. 6,0 |
| 111CNBIB64 | mm. 6,4 |
| 111CNBIB80 | mm. 8,0 |
| 111CNBIB10 | mm. 10,0 |
| 111CNBIB12 | mm 12,0 |

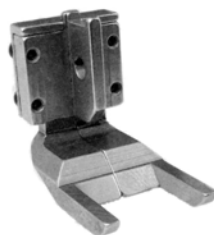
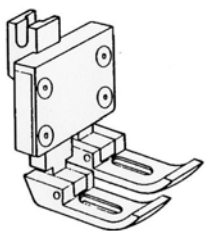

111CBIP008

Piedino a bilancino doppio
per piedino interno fino a 8 mm.

111CBIP010

Piedino a bilancino doppio
per piedino interno fino a 10 mm.

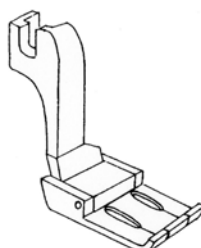
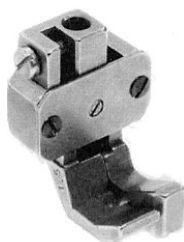
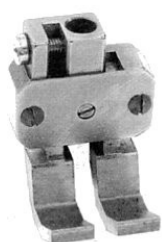

| Suola regolare Regular bottom | | |
|-------------------------------|-------------|--------|
| Codice | Originale | Misura |
| 111CN30715 | 30715 | mm 4,8 |
| 111CN61044 | 961044.3.00 | mm 6 |
| 111CN61144 | 961044.3.10 | mm 6,4 |
| Suola stretta Narrow bottom | | |
| 111CN92048 | | mm 4,8 |
| 111CN92064 | | mm 6,4 |

Piedino a bilancino doppio

Piedino bilancino destro

111CBID010 mm. 1
111CBID020 mm. 2

111CBIDS10 mm. 1
111CBIDS15 mm. 1,5
111CBIDS25 mm. 2,5

Piedino per macchina 2 aghi
cl. 921, 922

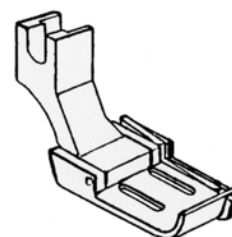
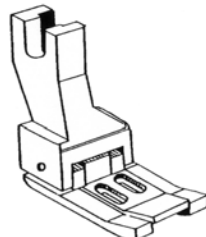
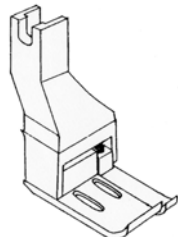
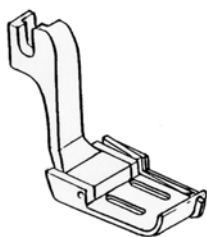

Piedino 2 aghi
con guida dx mm.2
cl. 921, 925

Compensatore destro 1/16"
cl. 921

Compensatore doppio 1/16"
cl. 921

Piedino 2 aghi
con guida dx mm.2
cl. 951, 971, 974, 976

| Codice | Misura | Codice | Misura | Codice | Misura | Codice | Misura |
|-------------------|--------|-------------------|--------|-------------------|--------|-------------------|--------|
| 111CND9248 | mm 4,8 | 111CN92D48 | mm 4,8 | 111CN92P48 | mm 4,8 | 111CND9748 | mm 4,8 |
| 111CND9264 | mm 6,4 | 111CN92D64 | mm 6,4 | 111CN92P64 | mm 6,4 | 111CND9764 | mm 6,4 |

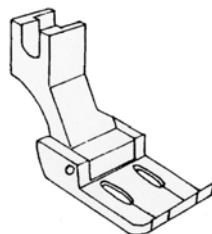

Piedino per macchina 2 aghi
cl. 951, 971, 974, 976

| Suola regolare | | |
|-------------------|-----------|--------|
| Codice | Originale | Misura |
| 111CN61799 | 961799.3 | mm 4,8 |
| 111CN61776 | 961773.3 | mm 6 |
| 111CN61773 | 961773.3 | mm 6,4 |
| Suola stretta | | |
| 111CN97048 | | mm 4,8 |
| 111CN97064 | | mm 6,4 |

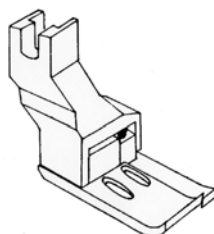

Compensatore destro 1/16"
cl. 951, 971, 974, 976

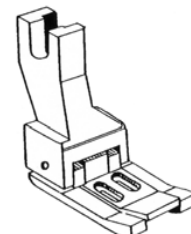

Compensatore doppio 1/16"
cl. 951, 971, 974, 976

| Codice | Misura | Codice | Misura |
|-------------------|--------|-------------------|--------|
| 111CN97D48 | mm 4,8 | 111CN97P48 | mm 4,8 |
| 111CN97D64 | mm 6,4 | 111CN97P64 | mm 6,4 |

 Piedino esterno 2 aghi
cl. 930

| Codice | Originale | Misura |
|------------|-----------|---------|
| 111CN61070 | 961070 | mm. 4,0 |
| 111CN61231 | 961231 | mm. 6,0 |
| 111CN61232 | 961232 | mm. 6,4 |
| 111CN61065 | 961065 | mm. 8,0 |
| 111CN61081 | 961081 | mm. 10 |
| 111CN61091 | 961091 | mm. 12 |
| 111CN61105 | 961105 | mm. 14 |
| 111CN61117 | 961117 | mm. 16 |
| 111CN61132 | 961132 | mm. 20 |

 Piedino interno 2 aghi
cl. 930

| Codice | Originale | Misura |
|------------|-----------|---------|
| 111CN61320 | 961320 | mm. 4,0 |
| 111CN61339 | 961339 | mm. 6,0 |
| 111CN61840 | 961840 | mm. 6,4 |
| 111CN61062 | 961062 | mm. 8,0 |
| 111CN61078 | 961078 | mm. 10 |
| 111CN61088 | 961088 | mm. 12 |
| 111CN61102 | 961102 | mm. 14 |
| 111CN61114 | 961114 | mm. 16 |
| 111CN61129 | 961129 | mm. 20 |

PIEDINI PER PFAFF

cl. 138, 141, 238

 111C000236
46682
Cucitura diritta

 111C000237
43522
Zig-Zag

 111CP26473
26473
Cordonatore destro

 111CP26474
26474
Cordonatore sinistro

 111CPP38ZZ
630 ZZ
Compensatore doppio Z/Z

 Piedino compensatore
cl. 142, 1242

| Destro | |
|----------------|-----------|
| 111CP610P | 1/32"=0,8 |
| 111CP611P | 1/16"=1,6 |
| 111CP612P | 1/8"=3,2 |
| 111CP613P | 3/16"=4,8 |
| 111CP614P | .1/4"=6,4 |
| Sinistro | |
| 111CP620P | 1/32"=0,8 |
| 111CP621P | 1/16"=1,6 |
| Doppio | |
| 111CP630P | 1/32"=0,8 |
| 111CP631P | 1/16"=1,6 |
| Destro stretto | |
| 111CP611NP | 1/16"=1,6 |

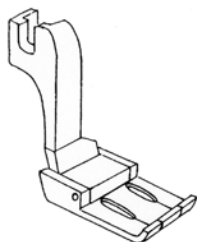
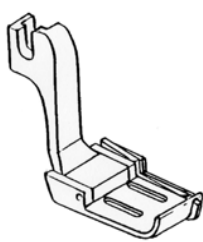
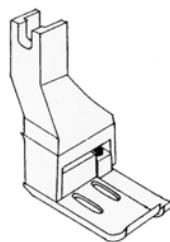
 Piedino per macchina 2 aghi
Suola regolare

 Piedino 2 aghi
con guida dx mm..2

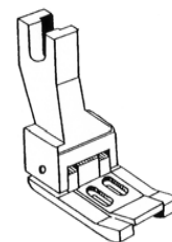
Compensatore destro 1/16"



Compensatore doppio 1/16"

| Codice | Originale | Misura | Codice | Misura | Codice | Misura | Codice | Misura |
|---------------|-----------|---------|------------|---------|------------|---------|------------|---------|
| 111CN30715 | 30715 | mm. 4,8 | 111CND9248 | mm. 4,8 | 111CN92D48 | mm. 4,8 | 111CN92P48 | mm. 4,8 |
| 111CN61044 | 961044 | mm. 6,0 | 111CND9264 | mm. 6,4 | 111CN92D64 | mm. 6,4 | 111CN92P64 | mm. 6,4 |
| 111CN61144 | 961044 | mm. 6,4 | | | | | | |
| Suola stretta | | | | | | | | |
| 111CN92048 | | mm. 4,8 | | | | | | |
| 111CN92064 | | mm. 6,4 | | | | | | |



| Codice | Originale | Misura |
|------------|-----------|---------|
| 111CN61070 | 961070 | mm. 4,0 |
| 111CN61231 | 961231 | mm. 6,0 |
| 111CN61232 | 961232 | mm. 6,4 |
| 111CN61065 | 961065 | mm. 8,0 |
| 111CN61081 | 961081 | mm. 10 |
| 111CN61091 | 961091 | mm. 12 |
| 111CN61105 | 961105 | mm. 14 |
| 111CN61117 | 961117 | mm. 16 |
| 111CN61132 | 961132 | mm. 20 |

Piedino esterno 2 aghi
cl. 145, 146, 335, 545



| Codice | Originale | Misura |
|------------|-----------|---------|
| 111CN61320 | 961320 | mm. 4,0 |
| 111CN61339 | 961339 | mm. 6,0 |
| 111CN61840 | 961840 | mm. 6,4 |
| 111CN61062 | 961062 | mm. 8,0 |
| 111CN61078 | 961078 | mm. 10 |
| 111CN61088 | 961088 | mm. 12 |
| 111CN61102 | 961102 | mm. 14 |
| 111CN61114 | 961114 | mm. 16 |
| 111CN61129 | 961129 | mm. 20 |

Piedino interno 2 aghi

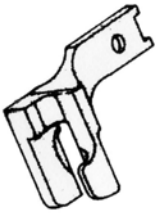

| Codice | Misura |
|------------|--------|
| 111CP54418 | 1/8" |
| 111CP54452 | 5/32" |
| 111CP54436 | 3/16" |
| 111CP54414 | 1/4" |
| 111CP54456 | 5/16" |
| 111CP54438 | 3/8" |

Scanalato esterno ago destra 49544



| Codice | Misura |
|------------|--------|
| 111CP04718 | 1/8" |
| 111CP04752 | 5/32" |
| 111CP04736 | 3/16" |
| 111CP04714 | 1/4" |
| 111CP04756 | 5/16" |
| 111CP04738 | 3/8" |

Scanalato interno ago destra 49047

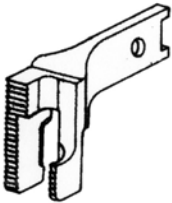

| Codice | Misura |
|------------|--------|
| 111CP54T18 | 1/8" |
| 111CP54T52 | 5/32" |
| 111CP54T36 | 3/16" |
| 111CP54T14 | 1/4" |
| 111CP54T56 | 5/16" |
| 111CP54T38 | 3/8" |

Scanalato esterno ago destra 49544T



| Codice | Misura |
|------------|--------|
| 111CP04T18 | 1/8" |
| 111CP04T52 | 5/32" |
| 111CP04T36 | 3/16" |
| 111CP04T14 | 1/4" |
| 111CP04T56 | 5/16" |
| 111CP04T38 | 3/8" |

Scanalato interno ago destra 49047T

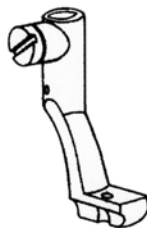
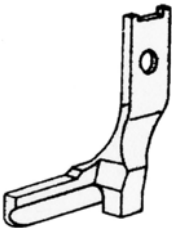

Scanalato esterno ago destra
42443

Scanalato interno ago destra
42442

111CP44336 3/16"
111CP44314 1/4"

111CP44236 3/16"
111CP44214 1/4"

Scanalato doppio esterno
42180

111CP21801 3/16"
111CP21802 1/4"

Scanalato doppio interno
42180

111CP21811 3/16"
111CP21812 1/4"

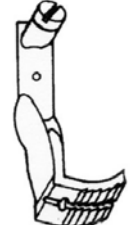
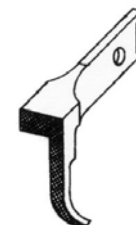
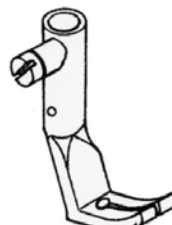
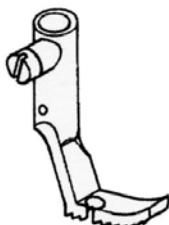

111CP49558
49558 C-D

111CP49085
49085 C

111CP46970
46970

111CP47404
40474-4

111CP47505
40475-5

111CP47405
40474-5

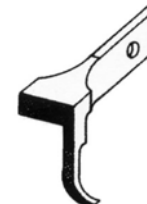
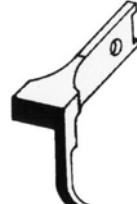
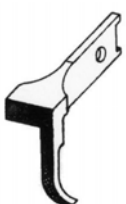

111CP47506
40475-6

111CP47406
40474-6

111CP47508
40475-8

111CP47408
40474-8

111CP44227
44227

111CP42819
42819

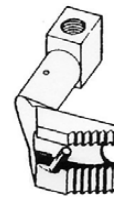
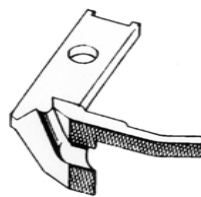
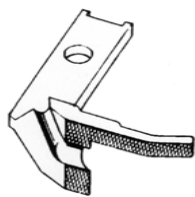

Scanalato destro esterno

Scanalato ago a destra interno

Scanalato destro esterno

Scanalato ago a destra interno

| Codice | Misura | Codice | Misura | Codice | Misura | Codice | Misura |
|------------|--------|------------|--------|------------|--------|------------|--------|
| 111CNE1D02 | mm. 2 | 111CAADD02 | mm. 2 | 111CNE1D02 | mm. 2 | 111CABDD02 | mm. 2 |
| 111CNE1D03 | mm. 3 | 111CAADD03 | mm. 3 | 111CNE1D03 | mm. 3 | 111CABDD03 | mm. 3 |
| 111CNE1D04 | mm. 4 | 111CAADD04 | mm. 4 | 111CNE1D04 | mm. 4 | 111CABDD04 | mm. 4 |
| 111CNE1D05 | mm. 5 | 111CAADD05 | mm. 5 | 111CNE1D05 | mm. 5 | 111CABDD05 | mm. 5 |
| 111CNE1D06 | mm. 6 | 111CAADD06 | mm. 6 | 111CNE1D06 | mm. 6 | 111CABDD06 | mm. 6 |
| 111CNE1D07 | mm. 7 | 111CAADD07 | mm. 7 | 111CNE1D07 | mm. 7 | 111CABDD07 | mm. 7 |
| 111CNE1D08 | mm. 8 | 111CAADD08 | mm. 8 | 111CNE1D08 | mm. 8 | 111CABDD08 | mm. 8 |
| 111CNE1D09 | mm. 9 | 111CAADD09 | mm. 9 | 111CNE1D09 | mm. 9 | 111CABDD09 | mm. 9 |
| 111CNE1D10 | mm. 10 | 111CAADD10 | mm. 10 | 111CNE1D10 | mm. 10 | 111CABDD10 | mm. 10 |
| 111CNE1D11 | mm. 11 | 111CAADD11 | mm. 11 | 111CNE1D11 | mm. 11 | 111CABDD11 | mm. 11 |
| 111CNE1D12 | mm. 12 | 111CAADD12 | mm. 12 | 111CNE1D12 | mm. 12 | 111CABDD12 | mm. 12 |

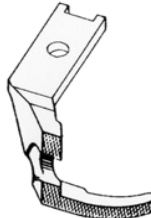
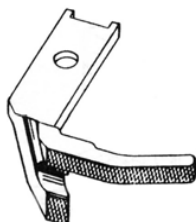

Scanalato destro esterno

Scanalato ago a destra interno

Scanalato sinistro esterno

Scanalato ago a sinistra interno

| Codice | Misura | Codice | Misura | Codice | Misura | Codice | Misura |
|------------|--------|------------|--------|------------|--------|------------|--------|
| 111CNE2D02 | mm. 2 | 111CACDL02 | mm. 2 | 111CNE4S02 | mm. 2 | 111CAESL02 | mm. 2 |
| 111CNE2D03 | mm. 3 | 111CACDL03 | mm. 3 | 111CNE4S03 | mm. 3 | 111CAESL03 | mm. 3 |
| 111CNE2D04 | mm. 4 | 111CACDL04 | mm. 4 | 111CNE4S04 | mm. 4 | 111CAESL04 | mm. 4 |
| 111CNE2D05 | mm. 5 | 111CACDL05 | mm. 5 | 111CNE4S05 | mm. 5 | 111CAESL05 | mm. 5 |
| 111CNE2D06 | mm. 6 | 111CACDL06 | mm. 6 | 111CNE4S06 | mm. 6 | 111CAESL06 | mm. 6 |
| 111CNE2D07 | mm. 7 | 111CACDL07 | mm. 7 | 111CNE4S07 | mm. 7 | 111CAESL07 | mm. 7 |
| 111CNE2D08 | mm. 8 | 111CACDL08 | mm. 8 | 111CNE4S08 | mm. 8 | 111CAESL08 | mm. 8 |
| 111CNE2D09 | mm. 9 | 111CACDL09 | mm. 9 | 111CNE4S09 | mm. 9 | 111CAESL09 | mm. 9 |
| 111CNE2D10 | mm. 10 | 111CACDL10 | mm. 10 | 111CNE4S10 | mm. 10 | 111CAESL10 | mm. 10 |
| 111CNE2D11 | mm. 11 | 111CACDL11 | mm. 11 | 111CNE4S11 | mm. 11 | 111CAESL11 | mm. 11 |
| 111CNE2D12 | mm. 12 | 111CACDL12 | mm. 12 | 111CNE4S12 | mm. 12 | 111CAESL12 | mm. 12 |

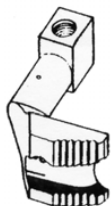
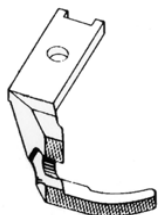

Scanalato sinistro esterno

Scanalato ago a sinistra interno

| Codice | Misura | Codice | Misura |
|------------|--------|------------|--------|
| 111CNE5S02 | mm. 2 | 111CAFSD02 | mm. 2 |
| 111CNE5S03 | mm. 3 | 111CAFSD03 | mm. 3 |
| 111CNE5S04 | mm. 4 | 111CAFSD04 | mm. 4 |
| 111CNE5S05 | mm. 5 | 111CAFSD05 | mm. 5 |
| 111CNE5S06 | mm. 6 | 111CAFSD06 | mm. 6 |
| 111CNE5S07 | mm. 7 | 111CAFSD07 | mm. 7 |
| 111CNE5S08 | mm. 8 | 111CAFSD08 | mm. 8 |
| 111CNE5S09 | mm. 9 | 111CAFSD09 | mm. 9 |
| 111CNE5S10 | mm. 10 | 111CAFSD10 | mm. 10 |
| 111CNE5S11 | mm. 11 | 111CAFSD11 | mm. 11 |
| 111CNE5S12 | mm. 12 | 111CAFSD12 | mm. 12 |

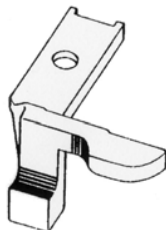
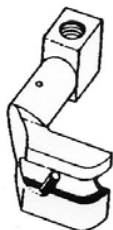
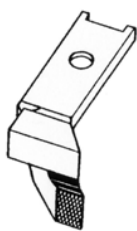

Sagomato destro esterno

Sagomato ago a destra interno

Sagomato destro esterno

Sagomato ago a destra interno

| Codice | Misura | Codice | Misura | Codice | Misura | Codice | Misura |
|------------|--------|------------|--------|------------|--------|------------|--------|
| 111CNE7D03 | mm. 3 | 111CAHDL03 | mm. 3 | 111CNE6D03 | mm. 3 | 111CAGDL03 | Mm. 3 |
| 111CNE7D04 | mm. 4 | 111CAHDL04 | mm. 4 | 111CNE6D04 | mm. 4 | 111CAGDL04 | Mm. 4 |
| 111CNE7D05 | mm. 5 | 111CAHDL05 | mm. 5 | 111CNE6D05 | mm. 5 | 111CAGDL05 | Mm. 5 |
| 111CNE7D06 | mm. 6 | 111CAHDL06 | mm. 6 | 111CNE6D06 | mm. 6 | 111CAGDL06 | Mm. 6 |
| 111CNE7D07 | mm. 7 | 111CAHDL07 | mm. 7 | 111CNE6D07 | mm. 7 | 111CAGDL07 | Mm. 7 |

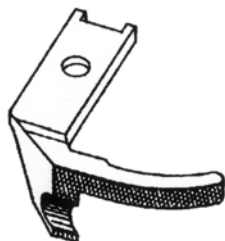

Sagomato destro esterno

Sagomato ago a sinistra interno

Sagomato sinistro esterno

Sagomato ago a destra interno

| Codice | Misura | Codice | Misura | Codice | Misura | Codice | Misura |
|------------|--------|------------|--------|------------|--------|------------|--------|
| 111CNE3D02 | mm. 2 | 111CAGDD02 | mm. 2 | 111CNE8D02 | mm. 2 | 111CAIDD02 | Mm. 2 |
| 111CNE3D03 | mm. 3 | 111CAGDD03 | mm. 3 | 111CNE8D08 | mm. 3 | 111CAIDD03 | Mm. 3 |
| 111CNE3D04 | mm. 4 | 111CAGDD04 | mm. 4 | 111CNE8D04 | mm. 4 | 111CAIDD04 | Mm. 4 |
| 111CNE3D05 | mm. 5 | 111CAGDD05 | mm. 5 | 111CNE8D05 | mm. 5 | 111CAIDD05 | Mm. 5 |
| 111CNE3D06 | mm. 6 | 111CAGDD06 | mm. 6 | 111CNE8D06 | mm. 6 | 111CAIDD06 | Mm. 6 |
| 111CNE3D07 | mm. 7 | 111CAGDD07 | mm. 7 | 111CNE8D08 | mm. 7 | 111CAIDD07 | Mm. 7 |
| 111CNE3D08 | mm. 8 | 111CAGDD08 | mm. 8 | 111CNE8D08 | mm. 8 | 111CAIDD08 | Mm. 8 |

PIEDINI A BILANCINO PER PFAFF

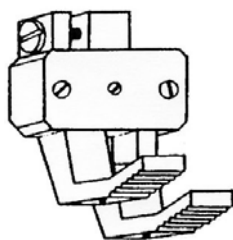

BASSI (2 VITI FRONTE)

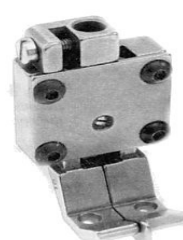

ALTI (4 VITI FRONTE)

| Dentato | | Liscio | | Con Guida centrale | |
|------------|----------|------------|----------|--------------------|----------|
| ALTO | | ALTO | | ALTO | |
| Codice | Misura | Codice | Misura | Codice | Misura |
| 111CABID48 | mm. 4,8 | 111CABIL48 | mm. 4,8 | 111CBIC048 | mm. 4,8 |
| 111CABID60 | mm. 6,0 | 111CABIL60 | mm. 6,0 | 111CBIC060 | mm. 6,0 |
| 111CABID64 | mm. 6,4 | 111CABIL64 | mm. 6,4 | 111CBIC064 | mm. 6,4 |
| 111CABID80 | mm. 8,0 | 111CABIL80 | mm. 8,0 | 111CBIC080 | mm. 8,0 |
| 111CABID10 | mm. 10,0 | 111CABIL10 | mm. 10,0 | 111CBIC100 | mm. 10,0 |
| BASSO | | BASSO | | BASSO | |
| 111CABBD48 | mm. 4,8 | 111CABBL48 | mm. 4,8 | 111CBBC048 | mm. 4,8 |
| 111CABBD60 | mm. 6,0 | 111CABBL60 | mm. 6,0 | 111CBBC060 | mm. 6,0 |
| 111CABBD64 | mm. 6,4 | 111CABBL64 | mm. 6,4 | 111CBBC064 | mm. 6,4 |
| 111CABBD80 | mm. 8,0 | 111CABBL80 | mm. 8,0 | 111CBBC080 | mm. 8,0 |
| 111CABBD10 | mm. 10,0 | 111CABBL10 | mm. 10,0 | 111CBBC100 | mm. 10,0 |

| ALTO | |
|-------------------|----------|
| Codice | Misura |
| 111CNBIA48 | mm. 4,8 |
| 111CNBIA60 | mm. 6,0 |
| 111CNBIA64 | mm. 6,4 |
| 111CNBIA80 | mm. 8,0 |
| 111CNBIA10 | mm. 10,0 |
| 111CNBIA12 | mm. 12,0 |
| BASSO | |
| 111CNBIB48 | mm. 4,8 |
| 111CNBIB60 | mm. 6,0 |
| 111CNBIB64 | mm. 6,4 |
| 111CNBIB80 | mm. 8,0 |
| 111CNBIB10 | mm. 10,0 |
| 111CNBIB12 | mm. 12,0 |

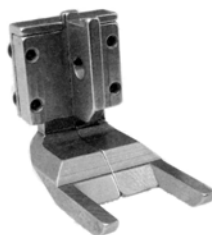
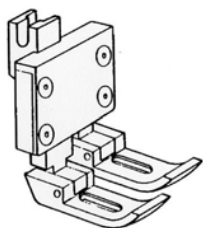

111CBIP008
Piedino a bilancino doppio
per piedino interno fino a 8 mm..

111CBIP010
Piedino a bilancino doppio
per piedino interno fino a 10 mm..

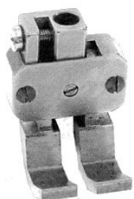

Piedino a bilancino doppio

111CBID010 mm.1
111CBID020 mm.2

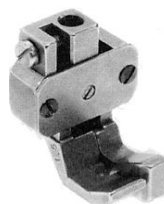

Piedino bilancino destro
111CBIDS10 mm.1,0
111CBIDS15 mm.1,5
111CBIDS25 mm.2,0

cl. 438, 442



Piedino Zig Zag
cl. 438

111CP43835 mm. 3,5
111CP43860 mm. 6,0

cl. 461, 481

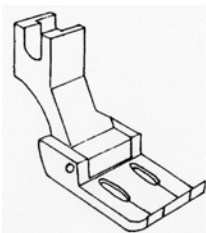

Piedino per macchina 2
aghi cl. 442

111CP44248 mm. 4,8
111CP44264 mm. 6,4

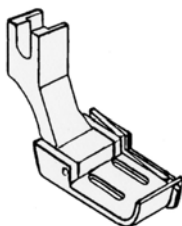

2 aghi con guida
cl. 442

| Guida destra | | Guida sinistra | |
|------------------|---------|------------------|---------|
| mm. 1 | | mm. 1 | |
| 111CPD481 | mm. 4,8 | 111CPS481 | mm. 4,8 |
| 111CPD641 | mm. 6,4 | 111CPS641 | mm. 6,4 |
| mm. 2 | | mm. 2 | |
| 111CPD482 | mm. 4,8 | 111CPS481 | mm. 4,8 |
| 111CPD642 | mm. 6,4 | 111CPS641 | mm. 6,4 |

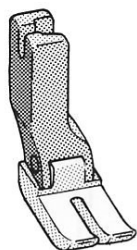

111CD700TE
Piedino teflon



111CD700TB
Ciabatta di ricambio

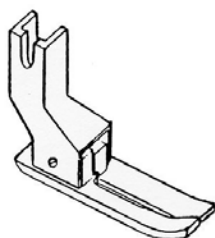

Piedino compensatore

| Destro | | | |
|-------------------|------------|-------------------|------------|
| Codice | Misura | | |
| 111CPD1132 | 1/32"=0,8 | | |
| 111CPD1116 | 1/16"=1,6 | | |
| 111CPD1018 | 1/8" =3,2 | Doppio | |
| 111CPD1316 | 3/16"=4,8 | Codice | Misura |
| 111CPD1014 | .1/4" =6,4 | 111CPP1132 | 1/32"=0,8 |
| 111CPD1072 | mm. 7,2 | 111CPP1116 | 1/16"=1,6 |
| 111CPD1080 | mm. 8,0 | Sinistro | |
| 111CPD1090 | mm. 9,0 | Codice | Misura |
| 111CPD1100 | mm. 10,0 | 111CPS1132 | 1/32"=0,8 |
| 111CPD1127 | mm. 12,7 | 111CPS1116 | 1/16"=1,6 |
| 111CPD1140 | mm. 14,0 | 111CPS1018 | 1/8" =3,2 |
| 111CPD1160 | mm. 16,0 | 111CPS1316 | 3/16"=4,8 |
| 111CPD1180 | mm. 18,0 | 111CPS1014 | .1/4" =6,4 |



111CD7518N

Piedino cern. invisibili con indice



111CD7518F

Piedino cern. invisibile



111CD7361N

Piedino cerniera destro



111CD7360N

Piedino cerniera sinistro



111CD7363V

Piedino cerniera



111CD7CC54
Piedino cerniera mm.5,4
111CD7CC70
Piedino cerniera mm. 7

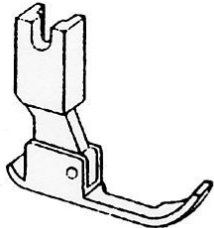

111CD7CD54
Cerniera dx mm.5,4
111CD7CD70
Cerniera dx mm. 7

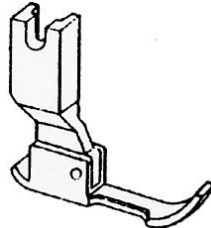

111CD7CS54
Cerniera sx mm.5,4
111CD7CS70
Cerniera sx mm. 7



111CD7CREG
Piedino cerniera regolabile

PIEDINI PER SINGER



111C000200
Zig Zag mm. 6 210569
cl. 107G, 107W, 143W,
307G, 457G, 457U



111C000201
Zig Zag mm. 5 241375
cl. 107G, 107W, 143W,
307G, 457G, 457U



111C000202
Grezzo S107B
cl. 107G, 107W, 143W,
307G, 457G, 457U



111C000203
Gambo 210620
cl. 107G, 107W, 143W,
307G, 457G, 457U



111C000204
Regolare 229882
cl. 111W, 211W,
211G



111CS41566
541566 mm. 10



111CS41781
541781 mm. 10



111CS43939
543939 mm. 12



111CS11314
411314



111CS03736
503736



111CS03660
503660



111CS13144
411314-4



111C23706
23706
Compensatore sinistro



111C23707
23707
Compensatore destro



111C266125
266125
Compensatore doppio



111CS107CL
107 CL mm. 6
Compensatore sinistro



111CS107CR
107 CR mm. 6
Compensatore destro



111CSPFA1L
PF-A1L mm. 10
Compensatore sinistro



111CSPFA1R
PF-A1R mm. 10
Compensatore destro



111CS0521Z
521Z
Compensatore sinistro



111CS07SCL
107 SCL mm. 6
Guida sinistra



111CS07SCR
107 SCR mm. 6
Guida destra



Piedino orlatore

| Codice | Misura |
|-------------------|---------|
| 111CS45725 | mm. 2,5 |
| 111CS45730 | mm. 3,0 |
| 111CS45740 | mm. 4,0 |
| 111CS45750 | mm. 5,0 |
| 111CS45760 | mm. 6,0 |



111CS0564A
210564 A4
Zig Zag per bordatori



111CS457AT
S457 AT mm. 10
Zig Zag con passa nastro



Piedino guida regolabile

| Codice | Misura |
|-------------------|--------|
| 111CS71S06 | mm. 6 |
| 111CS71S08 | mm. 8 |
| 111CS71S10 | mm. 10 |
| 111CS71S12 | mm. 12 |

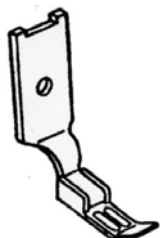

2 aghi per cerniere
259635 cl. 112W140
111CS25918 1/8"
111CS25936 3/16"
111CS25914 1/4"



Piedino 2 aghi con suola aperta cl. 112W, 112W, 212G, 212U, 212W
Anche per macchine **Juki** cl. LH 512, 515, **Consew, Seiko, Brother**

| Codice | Misura | Codice | Misura |
|-------------------|---------------|-------------------|----------------|
| 111CS23799 | 1/8" mm. 3,2 | | |
| 111CS23800 | 3/16" mm. 4,8 | 111CS24084 | 5/8" mm.15,9 |
| 111CS24062 | .1/4" mm. 6,4 | 111CS23771 | .3/4" mm.19,0 |
| 111CS24063 | 9/32" mm. 7,2 | 111CS24133 | 7/8" mm.22,2 |
| 111CS24064 | 5/16" mm. 8,0 | 111CS24068 | 1" mm.25,4 |
| 111CS24080 | 3/8" mm. 9,5 | 111CS24086 | 1,1/8" mm.28,6 |
| 111CS24081 | 7/16" mm.11,0 | 111CS24088 | 1,1/4" mm.31,8 |
| 111CS24082 | .1/2" mm.12,5 | 111CS24089 | 1,3/8" mm.34,9 |
| 111CS24083 | 9/16" mm.14,3 | 111CS24078 | 1,1/2" mm.37,9 |

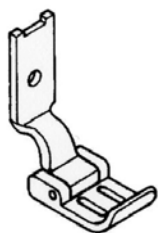

Piedino 2 aghi con suola chiusa cl. 112W, 112W, 212G, 212U, 212W
Anche per macchine **Juki** cl. LH 512, 515, **Consew, Seiko, Brother**

| Codice | Misura | Codice | Misura |
|-------------------|----------------|-------------------|----------------|
| 111CS24127 | 1/16" mm. 2,1 | 111CS23766 | 1/2" mm.12,5 |
| 111CS24158 | 3/32" mm. 2,4 | 111CS23767 | 9/16" mm.14,3 |
| 111CS24159 | 1/8" mm. 3,2 | 111CS23768 | 5/8" mm.15,9 |
| 111CS24160 | 5/32" mm. 4,0 | 111CS23769 | 3/4" mm.19,0 |
| 111CS24161 | 3/16" mm. 4,8 | 111CS23770 | 7/8" mm.22,2 |
| 111CS23759 | 7/32" mm. 5,6 | 111CS23772 | 1" mm.25,4 |
| 111CS23760 | 1/4" mm. 6,4 | 111CS23773 | 1,1/8" mm.28,6 |
| 111CS23761 | 9/32" mm. 7,2 | 111CS23774 | 1,1/4" mm.31,8 |
| 111CS23762 | 5/16" mm. 8,0 | 111CS23775 | 1,3/8" mm.34,9 |
| 111CS23763 | 11/32" mm. 8,7 | 111CS23776 | 1,1/2" mm.37,9 |
| 111CS23764 | 3/8" mm. 9,5 | 111CS23777 | 1,5/8" mm.41,3 |
| 111CS23765 | 7/16" mm.11,0 | 111CS23778 | 1,3/4" mm.44,4 |



| Codice | Misura | |
|-------------------|--------|---------|
| Guida mm.1,6 | | |
| 111CS57018 | 1/8" | mm. 3,2 |
| 111CS57036 | 3/16" | mm. 4,8 |
| 111CS57014 | 1/4" | mm. 6,4 |
| 111CS57056 | 5/16" | mm. 8,0 |
| 111CS57038 | 3/8" | mm. 9,5 |
| Guida mm. 0,8 | | |
| 111C000205 | 1/8" | mm. 3,2 |
| 111C000206 | 3/16" | mm. 4,8 |
| 111C000207 | 1/4" | mm. 6,4 |
| 111C000208 | 5/16" | mm. 8,0 |
| 111C000209 | 3/8" | mm. 9,5 |

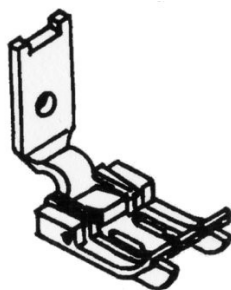

| Codice | Misura | |
|-------------------|--------|---------|
| Guida mm.1,6 | | |
| 111CS57D18 | 1/8" | mm. 3,2 |
| 111CS57D36 | 3/16" | mm. 4,8 |
| 111CS57D14 | 1/4" | mm. 6,4 |
| 111CS57D56 | 5/16" | mm. 8,0 |
| 111CS57D38 | 3/8" | mm. 9,5 |
| Guida mm. 0,8 | | |
| 111CS57G18 | 1/8" | mm. 3,2 |
| 111CS57G36 | 3/16" | mm. 4,8 |
| 111CS57G14 | 1/4" | mm. 6,4 |
| 111CS57G56 | 5/16" | mm. 8,0 |
| 111CS57G38 | 3/8" | mm. 9,5 |

Piedino 2 aghi con guida mobile destra
cl. 112W, 112W, 212G, 212U, 212W

Anche per macchine Juki , Consew, Seiko, Brother

PIEDINI PER SINGER, DURKOPP, JUKI

Piedino 2 aghi con guida mobile doppia
cl. 112W, 112W, 212G, 212U, 212W

Anche per macchine Juki , Consew, Seiko, Brother



111CS40148
240148



111CS40149
240149



111CS40135
240135



111CS40158
240158



111CS0158S
240158SSP



111CS0148H
240148H pesante

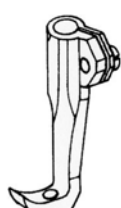

111CS0149H
240149H pesante



111CS40130
240130



111CS40154
240154



111CS40517
240517

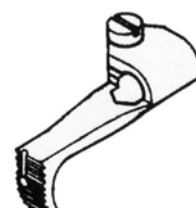

111CS40518
240518

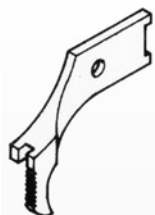

111CS40128
240128

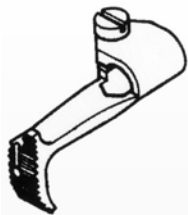

111CS40150
240150



111CS40551
240551

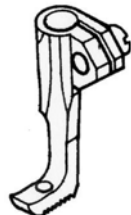

111CS40552
240552



111CS40133
240133



111CS40153
240153

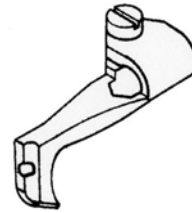
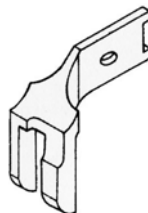
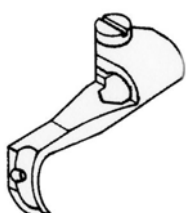
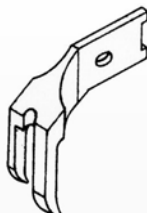

| Codice | | | Codice | | | Codice | | | Codice | | |
|-------------------|------|------|-------------------|------|------|-------------------|--------|------|-------------------|--------|------|
| 111CS31018 | S 31 | 1/8 | 111CS30018 | S 30 | 1/8 | 111CS40761 | 240761 | 1/8 | 111CS40762 | 240762 | 1/8 |
| 111CS31316 | S 31 | 3/16 | 111CS30316 | S 30 | 3/16 | 111CS40548 | 240548 | 3/16 | 111CS40549 | 240549 | 3/16 |
| 111CS31014 | S 31 | 1/4 | 111CS30014 | S 30 | 1/4 | 111CS40370 | 240370 | 1/4 | 111CS40371 | 240371 | 1/4 |
| 111CS31516 | S 31 | 5/16 | 111CS30516 | S 30 | 5/16 | 111CS40781 | 240781 | 5/16 | 111CS40782 | 240782 | 5/16 |

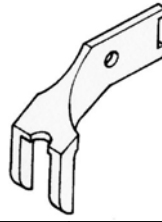
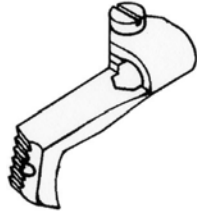
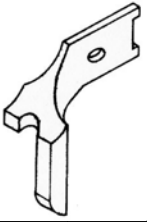

| Codice | | | Codice | | | Codice | | | Codice | | |
|-------------------|--------|------|-------------------|--------|------|-------------------|----------|------|-------------------|----------|------|
| 111CS40567 | 240567 | 3/16 | 111CS40569 | 240569 | 3/16 | 111CS0779N | 240779NS | 3/16 | 111CS0780N | 240780NS | 3/16 |
| 111CS40570 | 240570 | 1/4 | 111CS40568 | 240568 | 1/4 | 111CS0370N | 240370NS | 1/4 | 111CS0371N | 240371NS | 1/4 |
| 111CS40134 | 240134 | 5/16 | 111CS40157 | 240157 | 5/16 | 111CS0781N | 240781NS | 5/16 | 111CS0782N | 240782NS | 5/16 |



| Codice | Originale | Misura |
|-------------------|-----------|--------|
| 111CS17018 | 237178 | 1/8" |
| 111CS17316 | 237178 | 3/16" |
| 111CS17014 | 237178 | 1/4" |
| 111CS17516 | 237178 | 5/16" |
| 111CS17038 | 237178 | 3/8" |
| 111CS17012 | 237178 | 1/2" |
| 111CS17034 | 237178 | 3/4" |



| Codice | Originale | Misura |
|-------------------|-----------|--------|
| 111CS18018 | 237187 | 1/8" |
| 111CS18316 | 237187 | 3/16" |
| 111CS18014 | 237187 | 1/4" |
| 111CS18516 | 237187 | 5/16" |
| 111CS18038 | 237187 | 3/8" |
| 111CS18012 | 237187 | 1/2" |
| 111CS18034 | 237187 | 3/4" |

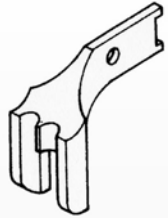

| Codice | Originale | Misura |
|-------------------|-----------|--------|
| 111CS94316 | S 94 | 3/16" |
| 111CS94014 | S 94 | 1/4" |
| 111CS94516 | S 94 | 5/16" |



| Codice | Originale | Misura |
|-------------------|-----------|--------|
| 111CS93316 | S 93 | 3/16" |
| 111CS93014 | S 93 | 1/4" |
| 111CS93516 | S 93 | 5/16" |

cl. 231

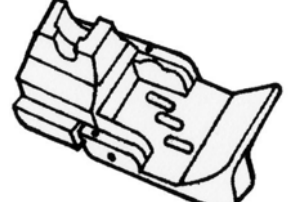
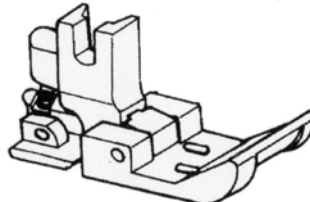
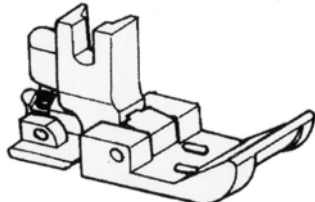

| Codice | | | Codice | | | Codice | | | Codice | | |
|-------------------|--------|-------|-------------------|--------|-------|-------------------|--------|-------|-------------------|--------|--|
| 110CS39245 | 139245 | 3/16" | 110CS61316 | 146615 | 3/16" | 110C000124 | 139138 | 3/16" | 110CS39405 | 139405 | |
| 110CS39246 | 139145 | 1/4" | 110CS61014 | 146615 | 1/4" | 110C000125 | 139138 | 1/4" | | | |

SALVADITO



110CB23364
S23364000
Brother cl. MA4



110CB07344
S07344101
Brother cl. LT2-B845



110CJ80701
118-20701
Juki cl. 2404,2414, 2504, 2514,
3604, 3614,3904, 3914



110CJ15408
121-15408
Juki cl. 3616, 3916

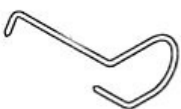

110CJ47700
121-15408
Juki cl. 3304, 3314, 3316

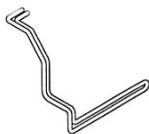

110CJ3131A
B3130-761-000A
Juki cl. LBH 1700



110CJ14710
B1471-562-00
Juki cl. LU 562, 563

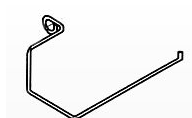

110CK79290
79-290 Kansai Sp cl. 1404, 1406
110CK79291
79-291 Kansai Sp cl. 1409, 1412

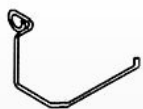

110CK79286
79-286

Kansai Sp cl. 8103, 8803, 9803

110CK79287
79-287

Kansai Sp cl. 8803UTC, 9803UTC



111CP53749
53749

Pfaff cl. 138, 238



111CRI0694
990694.0.00

Rimoldi cl. B27, B29, 227, 229

111CRI0693
990693.0.00

Rimoldi cl. 327, 329



111CRI0808
990808.0.01

Rimoldi cl. 261, 263, 264



111CS0005G
5G

Singer cl. 31-35, 95, 96,
241,251, 400W, 600W, 1 ago



111CS59081
259081

Singer cl. 107W, 111W, 143W,
153K, 153W, 457G, 1 ago



111CS34759
34759

Singer cl. 269W
Macchine travettatrici



111CS0019S
19S

Singer: 1 ago Pfaff cl. 434,
461, 463, 483 Union sp. 1 ago



111CS0011R
11R

Singer cl. 22W, 61W,107W



111CS0014R
14R

Singer cl. 112W, 212W



111CS0016A
16A

Singer cl. 108W



111CS59502
259502

Singer cl. 281



111CSPR122
PR122

Singer cl. 22W
Con piedino a rotella



111CS21344
121344

Singer cl. 147, 231, 253, 261,
262



110SMJ0160
MJ 16

Siruba cl: F007, C007



111CU1695U
21695U

Union Sp. Cl. 39500, 39600



111CU1695N
21695N

Union Sp. Cl. 5000 2 aghi



111CU1695P
21695P

Union Sp. Cl. 5000 1 ago



111CS0022G
22G

Macchine 2 aghi



111CSPR100
PR100

Macchine con piedino a rotella

PROTEZIONE PER OCCHI

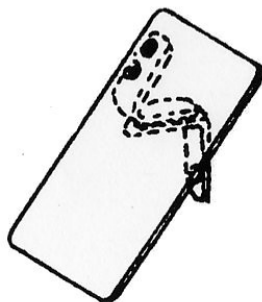

| Modello macchina | Numero originale | Codice |
|---|------------------|-------------------|
| Brother cl. LK-B430 | 153100-001 | 110CB53100 |
| Brother cl. CB3-B912 | 143972-001 | 110CB43971 |
| Blindstitch | 9552 (490510) | 110CBL9552 |
| Juki cl. MB-373 | B3120-372-OAO | 110CJ31203 |
| Juki cl. LK-980 | B3101-280-OAO | 110CJ31018 |
| Kansai Sp cl. 8103, 8803 | 20-627 | 110CK20627 |
| Singer cl. 69, 69, 114 Union Special, Reece | EG 104 | 110CS0G104 |
| Singer cl. 269W | 259832 | 110CS59832 |